

Date: 21st June 2021

To
Dr. A K Gupta
Joint Director (S)
Ministry Of Environment and Forests
Eastern Regional Office
A/3, Chandrashekharapur,
Bhubaneswar – 751 023

Sub.: Submission of 6 monthly Compliance Report of Joyville Howrah Project (Plot R2B) for the period of October'2020 to March'2021
EC Ref. No.: 2237/EN/T-II-1/126/2008/ (Pt-1), dated - 04.10.2016

Sir,

As per requirement for submission of the half yearly test report along with EC Compliance Report, we are enclosing herewith the following for your kind consideration:

- One half yearly compliance report for the period of October 2020 to March 2021 on the status of implementation of the stipulated conditions and environmental safeguard is submitted herewith.

We hope that you will do the needful in this regard.

Thanking you

Yours truly,

For Kolkata West International City Pvt. Ltd.

(Authorized Signatory)



Cc:

- West Bengal Pollution Control Board
- State Level Environment Impact Assessment Authority (SEIAA)

Kolkata West International City Private Limited

**Registered Office : "Vichitra" Kolkata West International City, Salap Junction, Howrah Amta Road and Bombay Road Crossing, NH6
Howrah - 711403, West Bengal, India • P : +91 33 3002 6000 F : +91 33 3025 6508 E : contact@kwic.co.in W : www.kolkatawest.com**

CIN No. : U45201WB2004PTC100310

SIX MONTHLY COMPLIANCE REPORT

October 2020 to March 2021



KOLKATA WEST INTERNATIONAL CITY PVT. LTD.

*“Vichitra”, Kolkata West International City
Salap Junction, Howrah Amta Road & Bombay
Road Crossing, NH6, Howrah - 711 403,
West Bengal*

PROJECT DETAILS

Shapoorji Pallonji Group has a legacy of more than 150 years of excellence in the construction industry in India and abroad. Today, Shapoorji Pallonji figures prominently among the leaders in this industry with more than 36,000 employees all over the world. The Company has made a strong statement in the real estate scenario with its premium residential projects in Kolkata, Howrah, Mumbai, Bangalore and other parts of the country. Joyville Shapoorji Housing Private Limited (formerly known as Drashti Developers Private Limited (DDPL) is engaged *inter alia* in the business of building



constructing, altering, acquiring, designing, erecting, establishing, equipping, developing, reconstructing, renovating, remodeling, rebuilding, undertaking, assisting, maintaining, managing, buying, selling, investing, leasing, letting on hire, commercializing, handling, controlling and acting as builders, civil engineers, architectural engineers, interior decorators, consultants, advisors, agents, brokers, supervisors, administrators, contractors, subcontractors, turnkey contractors, managers and dealers in all type of properties, real estate, buildings and structures including houses, Apartments, apartments, buildings, bungalows, residential township and projects, commercial complexes, offices etc.

By an Agreement to Sub-Lease dated 27th day of November, 2013 registered at the Office of the District Sub-Registrar, Howrah and recorded in Book No.I, CD Volume No.35, Pages from 2373 to 2414, Being No.10427, for the year 2013 (hereinafter referred to as **“the Agreement for Sub-Lease”**) as modified by Declaration dated 24th April, 2014 registered at the Office of the District Sub-Registrar, Howrah and recorded in Book No.4, Volume No.1 Pages from 5509 to 5516, Being No.00445, for the year 2014 (hereinafter referred to as **“the Declaration”**) and made between Kolkata West International City Pvt. Ltd. (KWICPL), as the Sub-Lessor and DDPL, as the Sub-Lessee, KWICPL has agreed to sub-lease on the terms and conditions therein contained., a part of the Demised Land admeasuring 30.385 (Thirty Point Three Eight Five) Acres or thereabouts (hereinafter referred to as **“the said Land”**) situated, lying and being at Mouzas Balitkuri, Pakuria and Khalia, District Howrah, West together with the multistoried residential buildings to be constructed thereon which

shall comprise of several self-contained independent apartments and other structures by utilizing development potential arising out of FAR of 36,00,000 (thirty six lakh) square feet [hereinafter referred to as **"the Building(s)"**], The said Land and the Building(s) to be constructed thereon are hereinafter referred to as (**"the said Property"**).

In terms of the Agreement for Sub-lease as modified by the Declaration, Joyville Shapoorji Housing Private Limited (JSHPL) is entitled to transfer, assign and /or mortgage all its rights under the said Agreement for Sub-Lease including its rights to built-up area constructed utilizing development potential arising out of FAR of 36,00,000 (Thirty Six Lac) Square Feet in respect of the said Property or any part thereof, to any third party.

The Company has fully paid the lease rent and the lease premium payable under the said Agreement for Sub-Lease for the said Property to KWIC. By declaration dated 6th January, 2016 KWIC has declared and confirmed the receipt of the rent and the lease premium and discharge the Company from the payment of the same or any part thereof. However the development cost of the said Property is being borne and paid by the Company.

By a Power of Attorney dated 27th November, 2013 KWICPL empowered DDPL inter alia, to execute Agreements/ Agreements for Transfer / Leave And License Agreement(s)/ Mortgage Deeds / Assignment Deeds / Memorandum of Understanding / Agreement of Sub-Lease / Sub-Lease Deeds / Power of Attorney / Declaration / Affidavit and Indemnity Bonds and all other Agreements and documents in the joint names of KWICPL and DDPL or otherwise as may be necessary to assign DDPL's interest under the said Agreement and/or sell/lease/let/license/mortgage or otherwise dispose of the said Property or parts thereof including the built-up area constructed on the said land or re-possess premises given on tenancy / license basis in the said Property and to receive the sale price / rent / license fees / lease premium and other consideration amounts from the Purchaser(s)/tenant(s)/lessee(s)/licensee(s) and to issue valid and effective receipts for the same to the purchaser(s)/tenant(s)/lessee(s)/licensee(s). The Power of Attorney as aforesaid was registered at the Office of the District Sub-Registrar, Howrah, in Book No.I, CD Volume No.35, Pages from 2415-2428, Being No.10428, for the year 2013.

The Company in the meantime, has passed Resolutions of its members for change of its name from Drashti Developers Private Limited (DDPL) to **"Joyville Shapoorji Housing Private**

Limited"("JSHPL") and accordingly, "Fresh Certificate of Incorporation Pursuant to Change of Name" [pursuant to Rule 29 of the Companies (Incorporation) Rules, 2014], was issued by the concerned Officer of the Registrar of Companies, Mumbai on 15th October, 2015.

The said Property is being developed and promoted by JSHPL by the name Joyville (hereinafter referred to as **"the said Project/Joyville Residential Township"**). The project has got Environmental Clearance from the concerned authority vide no. 2237/EN/T-II/126/2008(Pt-1), date 04.10.2016. The construction is going on full swing as per schedule of completion.

Total built up area of the project is 327439.95 sq.m The salient features of the project (Phase 2B) for which Environmental Clearance has been considered are given below :

Land Area	30.325 acres (122719 sqm.)
Latitude & Longitude	22°37'13.64"N & 88°17'25.91"E
Expected Population	18820 persons
Building profile	5 nos. of G+19, 7 nos. G+20 & 9 no G+21 storied
Total Water requirement	2940 KLD
Fresh water requirement	1763 KLD (source-KMDA supply)
Wastewater generated	2010 KLD (to be treated in Phase 2B STP)
Treated waste water recycled	1178 KLD (to be used in toilet flushing, landscaping & car washing)
Treated waste water discharge	833 KLD (to be discharged to Howrah drainage canal)
Solid waste disposal	10.5 TPD (to be disposed off through onsite compost plant & HMC)
Total Built-up Area	327439.95 sqm.
Ground Coverage	5.52 acres (22343.83 sqm.), (18.02% of land area)
Roads & Paved areas	7.54 acres (30530 sq.m) (24.88% of land area)
Exclusive tree plantation area	6.267 acres (25362 sq.m) (20.67% of land area)

Other Green area	9.96 acres (40301 sq.m) (35.22% of land area)
Waterbody	0.367 acres (1484 sq.m) (1.21% of land area)
No. of plantation proposed	1776 nos.
No. of Car Parking spaces proposed	3361 nos.(covered-1000 nos, open-2361 nos.)
Power requirement	13 MVA (at least 1% of total power requirement shall be met from solar power)
Use of solar power	At least 100 KW of solar power to be generated and utilized in addition to stand alone solar street lights inside Phase 2B
Backup Power	DG Sets (1x1010KVA, 2x750 KVA)

Project Status during up to March 2021:

At present the Phase 1A of the project is ready for handover. The project has obtained all the required permission and approvals from the respective concerned authorities to handover the apartments to its owners. The Project status up to March 2021 is as follows:

Tower A1 & A2: All building works are completed, handing over is in progress.

Tower B6 & B7: All building works are completed, handing over is in progress.

Podium – Parking Block: B+1 building works are completed.

Club House: All building works are completed.

PROJECT SITE PLAN



PROJECT LOCATION

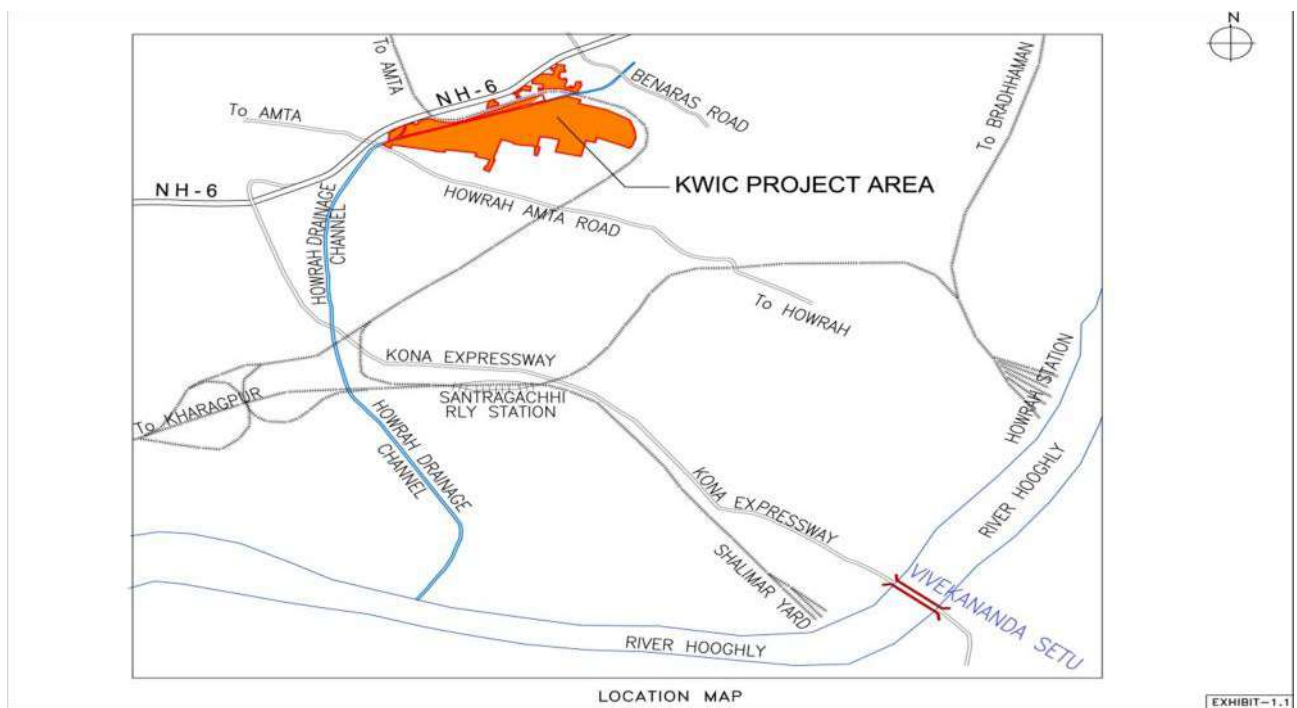
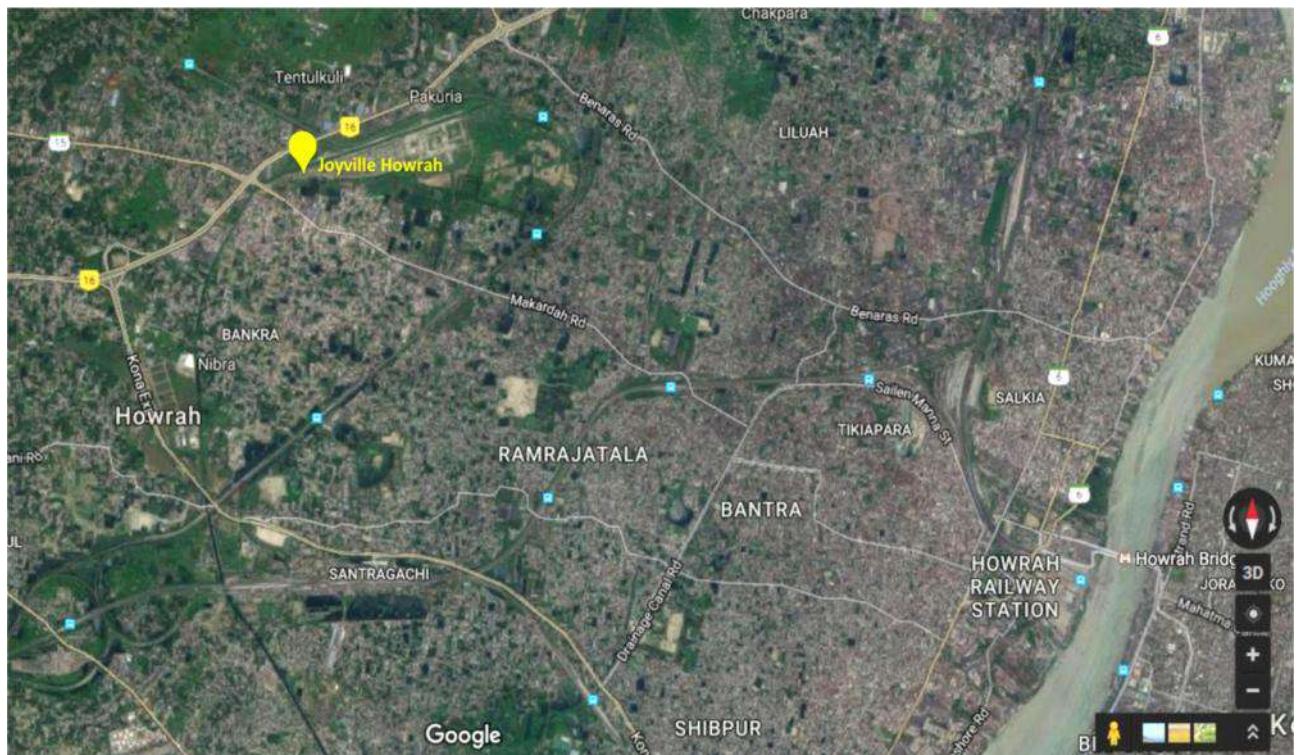

COMPLIANCE STATUS ON ENVIRONMENTAL CLEARANCES

For the Proposed Township Project

KOLKATA WEST INTERNATIONAL CITY PVT. LTD.

PROJECT NAME : 'JOYVILLE'

COMPLIANCE PERIOD : OCTOBER 20 TO MARCH 21

EC Ref. No. : 2237/EN/T-II-I/126/2008(Pt-1), dated 04.10.2016

A. SPECIFIC CONDITIONS

1. Construction Phase

Facility of laborers during construction:-

Sl.	Compliance conditions	:	Compliance status
i.	Provision of drinking water, wastewater disposal and solid waste management should be ensured for labour camps. Water usage during construction should be optimized to avoid any wastage.	:	Construction phase of the project has been completed. During construction phase provision of drinking water, wastewater disposal and solid waste management was ensured for labour camps. Water usage during construction was optimized to avoid any wastage.
ii.	Proper sanitation facilities should be provided for construction workers to ensure environmental sanitation. Sewage generated from the areas occupied by the construction laborers have to be directed into the existing sewage drain of the area. In case of non-availability of the sewer system, an onsite treatment system has to be provided.	:	Construction phase of the project has been completed. During construction phase proper sanitation facilities were provided for construction workers to ensure environmental safeguard. The Sewage water was treated with Hypochlorite Solution before sending it to Soak pit. The onsite treatment was done by Septic

Sl.	Compliance conditions	:	Compliance status
			tank for degradation of Sewage water.
iii.	The scaffolds, stairs and platforms for construction works and the workers must be secured as far as possible to prevent any accident.	:	Construction phase of the project has been completed. During construction phase the scaffolds, stairs and platforms for construction works and the workers were secured as far as possible to prevent any accident.
iv.	Health and safety of the workers should be ensured during construction. Personnel protective equipment like shoes, helmets, earmuffs, earplugs etc. should be provided to the workers. For vibration control damped tools must be used and the number of hours that a worker uses them must be limited. The Management must ensure that the workers put them while doing work that needs such protection, if any.	:	Construction phase of the project has been completed. During construction phase health and safety of the workers was the top priority for this project proponent. The unit had its own HSE policy for the Workers at site during construction. Personal protective equipment like shoes, helmets, earmuffs, earplugs etc. were provided to the workers. For vibration control damped tools are used and the number of hours that a worker uses was made limited. The Management had given clear instructions to the workers for using them while doing work that needs such protection, if any.
v.	Rest and convenience shelter for workers with crèche facility, if required, particularly for women, must be provided with proper toilet facilities.		Construction phase of the project has been completed. During construction phase there were available rest & convenience

Sl.	Compliance conditions	:	Compliance status
			shelter for workers inside the site. For women workers there were proper toilet facilities inside the project site.

Steps to avoid disturbance during construction

Sl.	Compliance conditions	:	Compliance status
i.	All the topsoil excavated during construction activities should be under cover / stored by retaining walls for use in horticulture / landscape development within the project site. Adequate erosion and sediment control measures to be adopted before ensuing construction activities.		Construction phase of the project has been completed. During construction phase all the excavated topsoil was stored for the use of horticulture / landscape development within the project site. Adequate erosion and sediment control measures were taken before ensuing construction activities.
ii.	Prior permission should be obtained from the competent authority for demolition of the existing structure, if any. Waste recycling plans should be developed for prior to beginning of demolition and construction activity. The plans should identify waste to be generated and designate handling, recycling and disposal method to be followed.		Construction phase of the project has been completed. During construction phase all necessary statutory permissions were obtained from the competent authority before start the construction. The Environmental Clearance was obtained from SEIAA as per the statutory requirement. Consent to Establish was obtained from West Bengal Pollution Control Board. (See the Annexures) . The appropriate Solid Waste Management was taken at the site to take care recycling and

Sl.	Compliance conditions	:	Compliance status
			disposal of waste generated during initial land development.
iii.	Disposal of muck including excavated material during construction phase should not create any adverse effects on the neighbouring communities and disposed of taking the necessary precautions for general safety and health aspects.	:	Construction phase of the project has been completed. During construction phase disposal of muck including excavated material during construction phase was not created any adverse effects on the neighbouring communities. For general safety and health aspects of the adjacent residents necessary precautions were adopted.
iv.	Diesel generator sets during construction phase should have acoustic enclosures and should conform to E (P) Rules prescribed for air and noise emission standards.	:	Construction phase of the project has been completed. During construction phase diesel generator sets were used with the necessary acoustic enclosures as per prescribed air & noise emission standards.
v.	Vehicles/equipment deployed during construction phase should be in good condition and should conform to applicable air and noise emission standards and should be operated only during non-peak hours.	:	Construction phase of the project has been completed. During construction phase the vehicles and equipment were regularly checked whether they were complying the air and noise standards. It is also directed that the Heavy machines were to be operated during non-peak hours.
vi.	Ambient noise levels should conform to residential standards both during day and	:	Construction phase of the project has been completed.

Sl.	Compliance conditions	:	Compliance status
	night. Fortnightly monitoring of ambient air quality (SPM, SO ₂ and NO _x) and equivalent noise levels should be ensured during construction phase.		During construction phase Ambient Noise levels were found to slightly high from residential standards during day time. Regular checking of the vehicles/instruments was done. Ambient air quality monitoring and noise level monitoring had been carried out by NABL Accredited Laboratory during the construction phase. The test report and graphical presentation are given in Annexures.
vii.	Construction spoils including bituminous material and other hazardous materials including oil from construction equipments must not be allowed to contaminate watercourses and the dumpsites for such material must be secured so that they should not leach into the ground water. If necessary, oil trap should be installed where there is deployment of heavy machineries.	:	Construction phase of the project has been completed. During construction phase the construction wastes materials were properly kept so that no contamination of land/water sources can take place. Necessary precautions were being taken during spillage of any lubricating oil during construction stage.
viii.	Regular supervision of the above and other measures should be in place all through the construction phase so as to avoid disturbance to the surroundings. Discomfort in the neighbourhood due to the proposed project activity should be minimized as far as practicable.	:	Construction phase of the project has been completed. During construction phase regular supervision of the entire preventive and safety measures were checked to avoid any degradation to the Environment, Health and Safety. The project

Sl.	Compliance conditions	:	Compliance status
			activity was done keeping all the conditions of the EC in line to minimize any consequential adverse effect of neighbourhood.
ix.	Loading and unloading operations should not be carried out in open areas and should be preferably done during day time, if there is any major settlement in the surrounding areas. The construction activities including Piling work, Operation of Ready Mix Plant and Vibrator etc. should not be carried out during the night time (10 p.m. to 6 a.m.). Only essential operations, if any, may be carried out for a limited period during nighttime.	:	Construction phase of the project has been completed. During construction phase Loading & unloading operations were being carried out in day time with proper management measures. The construction activities including Piling work, Operation of Ready Mix Plant and Vibrator etc. were done during day time. Only essential operations, if any, were carried out for a limited period during nighttime.
x.	The proponent must ensure that no driven piles shall be proposed for this project, if there is any major settlement in the surrounding areas.	:	Construction phase of the project has been completed. During construction phase driven pile was used in the construction activity as there was no such significant Settlement in the adjacent area.
xi.	15-m screen and adequate sprinkler arrangement shall be provided. Care should be taken to keep all material storages adequately covered and contained so that they are not exposed to winds.	:	Construction phase of the project has been completed. During construction phase the screen was used wherever it is required to avoid any spread of materials to the nearby areas. Material storages were properly covered so that they were not exposed to air. Adequate sprinkler arrangement

Sl.	Compliance conditions	:	Compliance status
			was kept reduce the spread of dust.
xii.	Use of Ready-mix concrete is recommended for this project.	:	Construction phase of the project has been completed. During construction phase the project proponent was directed to use Ready-mix concrete (RMC) during construction stage in this project.
xiii.	Adequate measures to be adopted to avoid wastage of water for curing of concrete structures.	:	Construction phase of the project has been completed. During construction phase the curing of concrete structure was done by using wet jute bag and making bund for storing water in flat roof structure.
xiv.	Adequate mitigative measures should be adopted to control dust emissions, noise and vibrations from construction activities. Vehicles and construction machineries should be properly maintained. Vehicles should conform to Pollution under control (PUC) norms.	:	Construction phase of the project has been completed. During construction phase adequate mitigative measures were being taken to control dust emissions, noise and vibrations from the construction activities. The vehicles were regularly checked whether they have valid PUC certification. Manual water sprinkling was done on the path way to keep the dust level in the surrounding at minimum range. See the Photographs.
xv.	Locally available materials with less transportation cost should be used preferably.	:	Construction phase of the project has been completed. During construction phase locally

Sl.	Compliance conditions	:	Compliance status
			available materials with less transportation cost were procured as far as possible.
xvi.	Promotion of use of cleaner fuel and fuel quality improvement should be done. Excessive energy consumption and fuel usage should be avoided.	:	Construction phase of the project has been completed. During construction phase H.S.D was being used as fuel for different equipment during construction stage.
xvii.	Accumulations / stagnation of water should be avoided to ensure vector control.	:	Construction phase of the project has been completed. During construction phase regular checking was done to see the site; so that no stagnation/accumulations of water can take place to ensure vector control.

Selection of materials for better energy efficiency

Sl.	Compliance Conditions	:	Compliance Status
i.	Use of energy efficient construction materials should be ensured to achieve the desired thermal comfort.	:	Construction phase of the project has been completed. During construction phase energy efficient construction materials were being used to achieve the desired thermal comfort.
ii.	Design layout is done in such a way, so that adequate solar access and should ensure adequate solar access and ventilation. Proper planning and window design for daylight integration should be considered.	:	Construction phase of the project has been completed. During construction phase design layout was done in such a way, so that adequate solar access ventilation

Sl.	Compliance Conditions	:	Compliance Status
			can be ensured. Proper planning and window design for daylight integration was considered.
iii.	Fly Ash is to be used for construction as per Notification No. S.O. 763(E) dated 14.09.1999 amended vide Notification No. S.O. 979(E) dated 27.8.2003 and S.O. 2804(E) dated 03.11.2009 of the Ministry of Environment & Forests, Govt. of India.	:	Construction phase of the project has been completed. During construction phase fly ash was used for filling of low lying area as per direction of MoEF. Fly Ash was used for construction as per Notification No. S.O. 763(E) dated 14.09.1999 amended vide Notification No. S.O. 979(E) dated 27.8.2003 and S.O. 2804(E) dated 03.11.2009 of the Ministry of Environment & Forests, Govt. of India.
iv.	Construction should conform to the requirements of local seismic regulations. The project proponent should obtain permission for the plans and designs including structural design, standard and specifications from concerned authority.	:	Construction phase of the project has been completed. During construction phase the project proponent had obtained permissions for the plans and designs including structural design, standard and specifications from concerned authority. Construction conformed to the requirements of local seismic regulations.
v.	Construction technologies that require less material and possess high strength should be adopted. Materials with low embodied energy and high strength should be used preferably.	:	Construction phase of the project has been completed. During construction phase construction technologies that require less material and possess high

Sl.	Compliance Conditions	:	Compliance Status
			strength was adopted.
vi.	The building will be constructed and provisioned to use natural sunlight to the maximum during the daytime, during use.	:	Construction phase of the project has been completed. During construction phase the use of natural sunlight was considered in the architectural design of the building as a whole.
vii.	Use of alternate building materials and alternate construction techniques should be considered apart from the conventional materials and methods. Use of hollow unit masonry should be considered.	:	Construction phase of the project has been completed. During construction phase fly ash-based cement was being used as alternative building material during construction.
viii.	Use of energy efficient lighting systems e.g. High Pressure Sodium Vapour (HPSV) Lamps, LED etc. should be promoted. Solar energy should be used for outdoor lighting. Adequate no. of solar lights should be installed for external lighting as per norms. All common area lighting will be LED system.	:	Construction phase of the project has been completed. During construction phase use of energy efficient lighting systems e.g. High Pressure Sodium Vapour (HPSV) Lamps, LED etc. was being advised. During construction the entire site area lighting was being done by LED Lights. Project Proponent had made a plan to use solar lights for external lighting as per norms.
ix.	Solar water heating arrangement will be done for water heating.	:	Construction phase of the project has been completed. During construction phase the use of Solar Heater was under design and feasibility review. It will be used at the time of operation stage.

Sl.	Compliance Conditions	:	Compliance Status
x.	Passive solar cooling to be incorporated in building design. Buildings should be oriented for ensuring natural ventilation and day lighting.	:	Construction phase of the project has been completed. During operation phase it will be implemented.
xi.	Proper insulation of roof should be provided to achieve desired thermal comfort. Use of light colored, reflective roofs having an SRI (solar reflectance index) of 50% or more should be incorporated.	:	Construction phase of the project has been completed. During construction phase to achieve desired thermal comfort high reflective materials were being used in roof.
xii.	Use of high albedo or reflective pavements to keep parking lots, pavements and inside roads cool should be incorporated.	:	Construction phase of the project has been completed. During construction phase all the suggestions were being taken care regarding Parking Lots, Pavements and Inside roads.
xiii.	Guidelines to the occupants should include usage efficiency measures such as energy efficient lighting and water efficient system.	:	During Operation Phase it will be done.
xiv.	Reduce hard paving-on-site (open area surrounding building premises) and / or provide shade on hard paved surfaces to minimize heat island effect and imperviousness of the site.	:	Construction phase of the project has been completed. During construction phase it was taken care of as per the National Building Code guidelines during operation phase.
xv.	Adequate open space, greenery and water bodies to be provided as per rules.	:	Adequate Open space Greenery and water bodies are being provided in this project.
xvi.	Any proposed building with air-conditioning facility should follow the norms proposed in the ECBC regulations framed by the Bureau	:	Construction phase of the project has been completed. During construction phase it was

Sl.	Compliance Conditions	:	Compliance Status
	of Energy Efficiency. Chillers should be CFC & HCFC free.		noted and it will be complied in operation stage.
xvii.	Restrict the use of glazed surface as per National Building Code 2005.	:	Construction phase of the project has been completed. During construction phase use of glazed surface was adhered to National Building Code 2005.

Water Body Conservation

Sl.	Compliance conditions	:	Compliance Status
1.	Water body if any should not be lined and their embankments should not be cemented. The water body is to be kept in natural conditions without disturbing the ecological habitat.	:	Construction phase of the project has been completed. There were no records of water body within the project premises.

Plantation Proposal

Sl.	Compliance conditions	:	Compliance Status
1.	The unit should strictly abide by The West Bengal Trees (Protection and Conservation in Non- Forest Areas) Rules, 2007. The proponent should undertake plantation of trees over atleast 20% of the total area.	:	Construction phase of the project has been completed. During construction phase the unit abided by the West Bengal Trees Rules, 2007. The Project Proponent undertook plantation of trees over atleast 20% of the total area during operation stage. It will be implemented during operation phase.
ii.	No trees can be felled without prior permission from the Tree Cutting Authority constituted as per the West Bengal Trees	:	Construction phase of the project has been completed. During construction phase no tree was

Sl.	Compliance conditions	:	Compliance Status
	(Protection and Conservation in Non-Forest Areas) Act, 2006 and subsequent rules.		felled as per the West Bengal Trees (Protection and Conservation in Non-Forest Areas) Act, 2006 and subsequent rules.
iii.	The proponent should plant at least 1776 trees as proposed. Indicative list of species is given at Annexure 1. The landscape planning should include plantation of native species. The species with heavy foliage and wide canopy cover are desirable. Water intensive and / or invasive species should not be used for landscaping.	:	Plantation programme will be done as per EC Guidelines by SEIAA, West Bengal during Operation Phase.
iv.	Provision for Roof Top Gardening is mandatory.	:	The feasibility of roof top gardening will be checked before its implementation during operation phase.

Water Supply

Sl.	Compliance conditions	:	Compliance Status
i.	Water requirement during construction phase shall be met from KMDA supply. Ground water should not be abstracted without prior permission of the competent authority as per the West Bengal Ground water Resources (Management, Control and Regulation) Act, 2005.		Construction phase of the project has been completed. During construction phase water requirement was met from bore well. Water meter had been installed and consumption was being monitored regularly.

Sewage Treat Plant

Sl.	Compliance conditions	:	Compliance Status
i.	As per the proposal submitted by the proponent waste water shall be treated in septic tank to soak pit. Construction waste water to be collected in sedimentation trap with adequate retention time and to be reused.		Construction phase of the project has been completed. During construction phase domestic wastewater was treated in a septic tank followed by soak pit. Construction waste water was collected through sedimentation trap with adequate retention time for reused.

Storm-water Management & Mitigation of Heat Island Effect

Sl.	Compliance conditions	:	Compliance Status
i.	Imperviousness of the site shall not exceed the NBC (National Building Code 2005) standards for imperviousness factor applicable to different types of area.	:	Construction phase of the project has been completed. During construction phase it was noted.
ii.	Total paved area of site under parking, roads, paths or any other use should not exceed 25% of the site area.	:	Construction phase of the project has been completed. During construction phase it was noted and it was complied with as per the EC guidelines by SEIAA.
iii.	Minimum 50% of paved area on site should have pervious paving or shaded under vegetation or topped with finish having solar reflectance of 0.5 or higher.	:	Construction phase of the project has been completed. During construction phase it was noted and it was complied with as per the EC guidelines by SEIAA.
iv.	Adequate storm-water drainage network to be designed for the project without disturbing the surrounding settlements. Storm water management plan should be	:	Construction phase of the project has been completed. During construction phase it was noted and it was designed accordingly

Sl.	Compliance conditions	:	Compliance Status
	implemented so as to prevent sudden discharge of excessive volumes of storm water to the receiving waters thus reducing the shock load on the drainage system and impact on receiving water body.		in order to comply the recommendation.
v.	Disruption to the natural hydrology of the site should be minimized by reducing impervious cover, increasing on site infiltration and managing storm water runoff.	:	There will not be any disruption of natural hydrology of the site.
vi.	Heat island effect should be minimized by use of shading or reflective surfaces, mainly the surfaces that contribute to the heat island effect i.e. streets, sidewalks, parking lots and buildings. White roofs should be provided in the buildings.	:	Construction phase of the project has been completed. During construction phase the proposal was under review and feasibility study is going on. Big trees is planted (at required intervals) along the roads. See the photographs .

Rain Water Harvesting Scheme

Sl.	Compliance conditions	:	Compliance Status
i.	The proponent must follow the Rainwater Harvesting Guidelines of the State Expert Appraisal Committee (SEAC) available in the website. (http://www.wbpcb.gov.in).	:	The Rainwater Harvesting Guidelines of the SEAC, as available in the web site of WBPCB will be followed by the project proponent during Operation stage.
ii.	The proponent must collect rainwater from roof-top catchments and reuse for various purposes after necessary cleaning.	:	Rainwater from roof-top catchments and reuse for various purposes after necessary

Sl.	Compliance conditions	:	Compliance Status
	Adequate retention time and storage provisions should be provided for harvesting rainwater.		cleaning. During operation phase it will be implemented.
iii.	Adequate water storage for firefighting should be provided as per norms	:	During construction phase it was maintained. Adequate water storage will be provided for Firefighting as per norms during operation phase.

Municipal Solid Waste Management

Sl.	Compliance conditions	:	Compliance Status
i.	Adequate provision shall be made for storage and segregation of solid waste and adequate means of access shall be provided.	:	Provision for adequate storage of solid waste will be made during Operation Stage. Necessary Solid Waste Handling facilities will be implemented in Operation phase.

Transport Management

Sl.	Compliance conditions	:	Compliance Status
i.	Both internal and external traffic planning and management should be adequate to ensure uninterrupted traffic movement in the area during construction as well as operation phase.	:	Traffic movement was fully restricted and controlled during construction phase. Separate entry & exit and adequate traffic signal will be provided during operation phase. Internal roads will be of moderate width for smooth traffic circulation. It will be same during operation stage.
ii.	The design of service road and the entry and exit from the project area should conform to the norms & standards of	:	The design of service road and the entry and exit from the project area will conform to the

Sl.	Compliance conditions	:	Compliance Status
	competent authority for traffic management. Bell mouth type arrangement should be made at the entry & exit. Proper traffic management plan should be adopted in consultation with Traffic authorities.		norms & standards of competent authority for traffic management. Bell mouth type arrangement will be made at the entry & exit. Proper traffic management plan will be adopted in consultation with Traffic authorities during Operation stage.
iii.	Clarified Wastewater will be used for sprinkling water on the unpaved internal roads on a regular basis.	:	Clarified wastewater was being used during construction stage and it will be used on a regular basis during operation phase also.

Others

Sl.	Compliance conditions	:	Compliance Status
i.	All mandatory approvals and permission as required from Director of Explosives, Fire Department etc. should be obtained.	:	All the requisite approvals as applicable for the project will be obtained before start of the project operation.
ii.	Provision of Effective Controls and Building Management Systems such as Automatic Fire Alarm and Fire Detection and Suppression System etc. must be ensured.	:	Fire Alarm and Fire Detection and Suppression System etc. will be considered as per EC Guideline.
iii.	Efficient management of indoor air quality must be ensured for health and safety of the user.	:	Efficient management of indoor air quality will be ensured for health and safety of the user.
iv.	Adequate measures to be adopted for water conservation during construction and operation stage. Use of efficient irrigation equipment, evaporative cooling unit in air-conditioning system etc should be	:	Adequate measures were being used for water conservation during construction and it will be implemented during operation stage.

	considered.		
v.	Rest room facilities should be provided for service population.	:	Rest room facilities were being provided for service population during construction phase and this have been planned for the operational phase also.
vi.	Adequate access to fire tenders should be provided.	:	Adequate access to fire tenders will be provided.

II. Operation Phase

Water Supply

Sl.	Compliance conditions	:	Compliance Status
i.	Water requirement during construction phase shall be met from KMDA supply. Ground water should not be abstracted without prior permission of the competent authority as per the West Bengal Ground Water Resources (Management, Control and Regulation) Act, 2005.	:	The construction work of the project is completed. After getting Consent to Operate the Authority will hand over to the owners. During operation it will be applicable.
ii.	Use of water meter conforming to ISO standards should be installed at the inlet point of water uptake to monitor the daily water consumption and records to be maintained. Use of water efficient devices / fixtures and appliances should be promoted.	:	The construction work of the project is completed. After getting Consent to Operate the Authority will hand over to the owners. During operation it will be applicable.
iii.	Dual plumbing system to be installed for maximum use of treated wastewater.	:	The construction work of the project is completed. After getting Consent to Operate the Authority will hand over to the

Sl.	Compliance conditions	:	Compliance Status
			owners. During operation it will be applicable.
iv.	The proponent must practice rainwater harvesting on regular basis.	:	The construction work of the project is completed. After getting Consent to Operate the Authority will hand over to the owners. During operation it will be applicable.

Sewage Treatment Plant

Sl.	Compliance conditions	:	Compliance Status
i.	Dedicated STP to be provided for Phase 2B. Entire waste water shall be treated in STP. Treated waste water shall be partly reused for toilet flushing, landscaping, internal road and pavement cleaning etc. and rest to be discharged.	:	The construction work of the project is completed. After getting Consent to Operate the Authority will hand over to the owners. During operation it will be applicable.
ii.	Water meter to be installed at STP inlet & discharge outlet point of treated water and regular records to be maintained.	:	The construction work of the project is completed. After getting Consent to Operate the Authority will hand over to the owners. During operation it will be applicable.
iii.	Provision of backup power for operation of STP during power failure should be made.	:	The construction work of the project is completed. After getting Consent to Operate the

			<p>Authority will hand over to the owners.</p> <p>During operation it will be applicable.</p>
--	--	--	---

Emission from Diesel Generator Set :

Sl.	Compliance conditions	:	Compliance Status
i.	Noise barriers will be provided at appropriate locations so as to ensure that the noise levels do not exceed the prescribed standards. Diesel generator sets should be provided with integral acoustic enclosure at the manufacturing stage itself as per CPCB norms.	:	<p>The construction work of the project is completed. After getting Consent to Operate the Authority will hand over to the owners.</p> <p>During operation it will be applicable.</p>
ii.	The stack height and emissions from D.G. Sets should conform to the norms of Central Pollution Control Board. The certification of space design for DG sets should be done by competent authority.	:	<p>The construction work of the project is completed. After getting Consent to Operate the Authority will hand over to the owners.</p> <p>During operation it will be applicable.</p>

Ensure Energy Efficiency

Sl.	Compliance conditions	:	Compliance Status
i.	Use of energy efficient construction materials to achieve the desired thermal comfort should be incorporated. The desired level of R & U factor must be achieved. U factor for the top roof should not exceed 0.4 Watt / sq.m / degree centigrade with appropriate	:	<p>The construction work of the project is completed. After getting Consent to Operate the Authority will hand over to the owners.</p> <p>During operation it will be applicable.</p>

Sl.	Compliance conditions	:	Compliance Status
	modifications of specifications and building technologies. The provisions of National Building Code 2005 should be strictly followed.		
ii.	Use of energy efficient electrical systems should be promoted. High efficiency lamps with electronic ballasts should be used.	:	The construction work of the project is completed. After getting Consent to Operate the Authority will hand over to the owners. During operation it will be applicable.
iii.	Energy efficient Motors and properly rated Transformers should be installed. Manufacturer's certificate to this effect shall be obtained and kept on record. Backup power supply should be based on cleaner fuel.	:	The construction work of the project is completed. After getting Consent to Operate the Authority will hand over to the owners. During operation it will be applicable.
iv.	The power cabling shall be adequately sized as to maintain the distribution losses not to exceed 1% of the total power usage. Record of transmission losses shall be maintained. The proponent will install permanent electrical metering to record demand (kVA), energy (kWh) and total power factor.	:	The construction work of the project is completed. After getting Consent to Operate the Authority will hand over to the owners. During operation it will be applicable.
v.	At least 100 KW of solar power to be generated and utilized in addition to stand alone solar street lights inside Phase 2B.	:	The construction work of the project is completed. After getting Consent to Operate the Authority will hand over to the

Sl.	Compliance conditions	:	Compliance Status
			owners. During operation it will be applicable.
vi.	The project proponent should be used solar energy at least for street lighting.	:	The construction work of the project is completed. After getting Consent to Operate the Authority will hand over to the owners. During operation it will be applicable.

Transport Management

Sl.	Compliance conditions	:	Compliance Status
i.	Use of the public mode of transportation should be promoted. Use of least polluting type of transportation should be promoted. Adequate parking space should be provided as per norms	:	The construction work of the project is completed. After getting Consent to Operate the Authority will hand over to the owners. During operation it will be applicable.
ii.	Pathways should be covered or shadowed by tree canopy as far as practicable. Transport system should be such that traffic will be calm in neighbor hoods. Traffic within the project site should be restricted by regulation. Adequate vertical and horizontal clearances of overhead electric power and telecommunication lines should be provided.	:	The construction work of the project is completed. After getting Consent to Operate the Authority will hand over to the owners. During operation it will be applicable.

Sl.	Compliance conditions	:	Compliance Status
iii.	Dedicated cycle tracks should be included inside the Phase 2B.	:	The construction work of the project is completed. After getting Consent to Operate the Authority will hand over to the owners. During operation it will be applicable.

Solid Waste Management

Sl.	Compliance conditions	:	Compliance Status
i.	The proponent should abide by the Municipal Solid Wastes (Management and Handling) Rules, 2000. The proponent must develop the Solid Waste Management and Disposal Scheme ensuring storage and segregation of biodegradable and non-biodegradable wastes. The solid waste is to be disposed off in consultation with concerned municipality.	:	The construction work of the project is completed. After getting Consent to Operate the Authority will hand over to the owners. During operation it will be applicable.
ii.	The proponent shall install onsite compost plant for treatment of biodegradable part of Municipal solid Waste. Sufficient space for installation of onsite compost plant should be provided and operation of the compost plant considering full occupancy of the apartments i.e. the capacity of garbage disposal unit should be selected accordingly.	:	The construction work of the project is completed. After getting Consent to Operate the Authority will hand over to the owners. During operation it will be applicable.
iii.	The handling agency should also take care of the recyclable wastes like plastic, paper board, glass etc. and also inert materials in	:	The construction work of the project is completed. After getting Consent to Operate the

Sl.	Compliance conditions	:	Compliance Status
	case of respective municipal authorities want to avoid any kind of waste from the housing complex.		Authority will hand over to the owners. During operation it will be applicable.
iv.	The proponent should have sufficient area for horticulture where the compost generated can be used as fertilizer and soil supplement and also have arrangement for sale of excess quantity of compost.	:	The construction work of the project is completed. After getting Consent to Operate the Authority will hand over to the owners. During operation it will be applicable.
v.	Provision for treatment of leachate generated and odor control in onsite compost plant should be made.	:	The construction work of the project is completed. After getting Consent to Operate the Authority will hand over to the owners. During operation it will be applicable.
vi.	Non – recyclable inorganics and rejects will be disposed off through municipality as proposed.	:	The construction work of the project is completed. After getting Consent to Operate the Authority will hand over to the owners. During operation it will be applicable.
vii.	The proponent should provide different coloured bins for different categories of waste and ensure complete segregation of biodegradable and non-biodegradable	:	The construction work of the project is completed. After getting Consent to Operate the Authority will hand over to the

Sl.	Compliance conditions	:	Compliance Status
	wastes. The solid waste from different collection and storage bins should be finally collected at transfer stations. Further segregation will be done at transfer stations to collect recyclables such as plastic, polythene, glass, metals, textiles, rubbers, leathers, paper etc. Separate compartments shall be provided for each type of recyclables.		owners. During operation it will be applicable.
viii.	The proponent should abide by the Hazardous Wastes (Management, Handling and Transboundary Movement) Rules, 2008. Collection and storage of hazardous wastes during Pre-construction and Post-construction activity should be planned properly. The expected hazardous wastes should be disposed off separately as per the Hazardous Wastes (Management, Handling and Transboundary Movement) Rules, 2008.	:	The construction work of the project is completed. After getting Consent to Operate the Authority will hand over to the owners. During operation it will be applicable.
ix.	Spent oil from DG Sets should be stores in HDPE drums in isolated covered facility and disposed off as per the Hazardous Wastes (Management, Handling and Transboundary Movement) Rules, 2008. Spent oil from DG sets should be disposed off through registered recyclers only.	:	The construction work of the project is completed. After getting Consent to Operate the Authority will hand over to the owners. During operation it will be applicable.

Others

Sl.	Compliance conditions	:	Compliance Status
i.	The implementation of Environmental Management Plan should be carried out, as proposed. Regular monitoring should be carried out during construction and operation phases.	:	The construction work of the project is completed. After getting Consent to Operate the Authority will hand over to the owners. During operation it will be applicable.
ii.	The project proponent should provide guidelines to the users to ensure conservation of energy and water. In-house environmental awareness campaigns should be carried out at regular intervals to ensure environmental protection.	:	The construction work of the project is completed. After getting Consent to Operate the Authority will hand over to the owners. During operation it will be applicable.
iii.	Firefighting systems should be designed in compliance with the WBFS and NBC norms. Preventive measures should be adopted for Risk & Disaster Management as per the provisions of the National Building Code 2005.	:	The construction work of the project is completed. After getting Consent to Operate the Authority will hand over to the owners. During operation it will be applicable.
iv.	Public utility services such as common public toilets to be provided.	:	The construction work of the project is completed. After getting Consent to Operate the Authority will hand over to the owners. During operation it will be

Sl.	Compliance conditions	:	Compliance Status
			applicable.
v.	The Corporate Social Responsibility Plan with specific financial commitment should be implemented for the proposed project. At least 2% of the total project cost should be utilized for Corporate Social Responsibility programmes.	:	The construction work of the project is completed. After getting Consent to Operate the Authority will hand over to the owners. During operation it will be applicable.
vi.	The proponent should abide by the Direction issued by the Department of Environment, Government of West Bengal, vide No. EN/3170/T-IV-7/001/2009 dated 10.12.2009.	:	The construction work of the project is completed. After getting Consent to Operate the Authority will hand over to the owners. During operation it will be applicable.
vii.	Environmental Management Information System shall be maintained properly.	:	The construction work of the project is completed. After getting Consent to Operate the Authority will hand over to the owners. During operation it will be applicable.
viii.	The proponent should restrict the use of glazed surface as per National Building Code, 2005.	:	The construction work of the project is completed. After getting Consent to Operate the Authority will hand over to the owners. During operation it will be applicable.

Sl.	Compliance conditions	:	Compliance Status
ix.	All the recommendations made in the EIA/EMP report should be complied with.	:	The construction work of the project is completed. After getting Consent to Operate the Authority will hand over to the owners. During operation it will be applicable.
x.	Fraction of covered area that would be illuminated by natural lighting of the proposed buildings to be reported in the first compliance report.	:	The construction work of the project is completed. After getting Consent to Operate the Authority will hand over to the owners. During operation it will be applicable.
xi.	Fire escape, evacuation plan and means thereof, the refuge areas and floor levels to be reported in the first compliance report.	:	The construction work of the project is completed. After getting Consent to Operate the Authority will hand over to the owners. During operation it will be applicable.
xii.	All the conditions stipulated for individual phases in the EC for the whole township vide no. 572/EN/T-II-1/126/2008, dated 09.03.2016 should be complied with.	:	The construction work of the project is completed. After getting Consent to Operate the Authority will hand over to the owners. During operation it will be applicable.

PART B – GENERAL CONDITIONS

Sl.	Compliance conditions	:	Compliance Status
i.	The environmental clearance accorded shall be valid for a period of 7 years for the proposed project.	:	It is noted.
ii.	Prior Consent to Establish (NOC) for the proposed project must be obtained from WBPCB by the proponent. All other statutory clearance should be obtained by the project proponent from the competent authorities.	:	Consent to Establish is obtained from the West Bengal Pollution Control Board. All other statutory clearances will be obtained. The copy of Consent to Establish is in Annexure.
iii.	The proponent should maintain a display board at the site, providing detailed information on the salient features of the proposed project.	:	The proponent will maintain a display board at the site providing detailed information on the salient features of the proposed project.
iv.	The environmental safeguards contained in the E I A / EMP report should be implemented in letter and spirit.	:	It is noted and it will be done in letter and spirit.
v.	All the conditions, liabilities and legal provisions contained in the EC shall be equally applicable to the successor management of the project in the event of the project proponent transferring the ownership, maintenance of management of the project to any other entity.	:	All the conditions, liabilities and legal provisions contained in the EC will be equally applicable to the successor management of the project in the event of the project proponent transferring the ownership, maintenance of management of the project to any other entity.
vi.	Provision should be made for the supply of kerosene or cooking gas to the laborers during construction phase. All the labourers to be engaged for construction works	:	Provision is made for the supply of kerosene or cooking gas to the laborers during construction phase. All the labourers are

Sl.	Compliance conditions	:	Compliance Status
	should be screened for health and adequately treated before issue of work permits.		engaged for construction works is being screened for health and adequately treated before issue of work permits.
vii.	The project proponent should make financial provision in the total budget of the project for implementation of the suggested safeguard measures.	:	The project proponent has made financial provision in the total budget of the project for implementation of the safeguard measures.
viii.	Six-monthly monitoring reports should be submitted to the West Bengal Pollution Control Board, who would be monitoring the implementation of environmental safeguards and should be given full cooperation, facilities and documents / data by the project proponents during their inspection. A complete set of all the documents should also be forwarded to the State Level Environment Impact Assessment Authority, West Bengal.	:	Six-monthly monitoring reports are submitted to the West Bengal Pollution Control Board, the monitoring authority regarding environmental safeguards. They are given full cooperation, facilities and documents / data by the project proponents during their inspection. A complete set of all the documents is also forwarded to the State Level Environment Impact Assessment Authority, West Bengal.
ix.	In case of any violation of the conditions laid down in this Environmental Clearance, Section 16 of The Environment (Protection) Act, 1986, will be applicable. In case of any change(s) in the scope of the project, the project would require a fresh appraisal by the SEIAA, West Bengal.	:	It is noted.

Sl.	Compliance conditions	:	Compliance Status
x.	The State Level Environment Impact Assessment Authority, West Bengal reserves the right to add additional safeguard measures subsequently, if found necessary, and to take action including revoking of the environment clearance under the provisions of the Environmental (Protection) Act, 1986, to ensure effective implementation of the suggested safeguard measures in a time-bound and satisfactory manner.	:	The project proponent is agreed to abide by the direction for the additional safeguard of environment as far as applicable. Under the provisions of the Environmental (Protection) Act, 1986, effective implementation of the suggested safeguard measures in a time-bound and satisfactory manner will be ensured.
xi.	The project Proponent should inform the public that the proposed project has been accorded environmental clearance by the SEIAA, West Bengal and copies of the Clearance letter are available with the State pollution Control Board / Committee and may also be seen at website of the SEIAA, West Bengal (http://environmentwb.gov.in). This should be advertised within seven days from the date of issue of the clearance letter, at least in two local newspapers that are widely circulated in the region of which one shall be in the vernacular language of the locality concerned.	:	The project proponent has already published the information regarding the Environmental Clearance for the project in two widely circulated Local Newspapers, one in English and the other in Bengali. See the Annexures.
xii.	All other statutory clearance such as the approvals for storage of diesel from Chief Controller of Explosives, Civil Aviation Department (if required) etc. shall be obtained by project proponents from the competent authorities.	:	All the requisite approvals as applicable for the project will be kept before start of operation phase.

Sl.	Compliance conditions	:	Compliance Status
xiii.	Provision for incorporation of appropriate conditions in the Sale Agreement / Deed, for ensuring sustained Operation and Maintenance (O&M) of the common facilities (STP, Rainwater harvesting system, Solid waste management system, Solar street lights etc.) even after transfer of ownership of the project, should be made in explicit and transparent manner.	:	It is noted and to be complied in line with the commitment noted in the Form IA.
xiv.	The above stipulations would be enforced along with those under the Water (Prevention and Control of Pollution) Act, 1974, the Air (Prevention and Control of Pollution) Act, 1981, the Environment (Protection) Act, 1986, the Hazardous Wastes (Management, Handling and Transboundary Movement) Rules, 2008, the Public Liability Insurance Act, 1991, the Environment Impact Assessment Notification 2006 and their amendments.	:	All the above statutory stipulations will be complied with in totality as per noted Notifications. The main objective of this project will be the overall positive outlook in regard to implementation of Proper and sustainable Environmental Management as a whole.



ENVIROCHECK

Recognised by MoEF&CC, WBPCB & JSPCB
Accredited by NABL (ISO/IEC 17025:2017)
Certified by ISO 9001:2015, ISO 14001:2015 & ISO 45001 : 2018



TEST REPORT

FORMAT NO : ENV/FM/38

Name of the Project	:	Kolkata West International City Pvt. Ltd. (Project Name : Joyville)	Type of Project	:	Housing Complex
Address	:	Salap More, Howrah – Amta Road, Bombay Road Crossing, Howrah – 711403	Sampling Date	:	18.03.2021
			Period of Analysis	:	19.03.2021 – 20.03.2021
			Date of Issue	:	22.03.2021
Sampling Plan & Procedure	:	ENV/SOP/01	Deviation from the Sampling Method and Plan	:	No
			Type of Sample	:	Source Emission
Sample ID No.	:	262/EC/M/TR(A)/I	Report No.	:	262/EC/M/TR(A)/I/20-21

A. GENERAL INFORMATION ABOUT STACK PROVIDED BY THE INDUSTRY

Stack Attached to	:	D. G. – 125 KVA (D. G. Yard) (Acoustic Enclosure)
Shape of Stack	:	Circular
Materials of Construction	:	M.S.
Capacity	:	125 KVA
Emission Due to	:	Combustion of H.S.D
Fuel Used	:	H.S.D
Working Fuel Consumption	:	12 liter./hr.
Pollution Control Device	:	Nil
Height of Stack (mtr.) (from G. L.)	:	3.0
Stack I.D. at sampling point (mtr.)	:	0.1016
Height of sampling port (mtr.) (from G.L.)	:	Final Exhaust
Permanent Platform & Ladder	:	No

B. RESULTS

SL. NO.	PARAMETERS	UNIT	METHOD NO.	RESULTS	LIMIT
1.	Flue Gas Temperature	°C	IS 11255 (Part 1)	52.0	N.A.
2.	Barometric Pressure	mm of Hg.	--	754.0	N.A.
3.	Velocity of Gas flow	m/s	IS 11255 (Part 3)	13.02	N.A.
4.	Quantity of Gas flow	Nm ³ /hr.	IS 11255 (Part III)	345.30	N.A.
5.	Concentration of SO ₂	mg/Nm ³	IS 11255 (Part 2) 1985 RA 2003	31.20	N.A.
6.	Concentration of NO _x	mg/Nm ³	IS : 11255 (Part 7) 2005 & ASTM D 1608-98 reapproved 2009 : Sec 11 (Vol. 11.07) : 2011	45.0	N.A.
7.	Concentration of CO ₂	% (v/v)	IS 13270 1992 RA 2003	6.5	N.A.
8.	Concentration of CO	% (v/v)	IS 13270 1992 RA 2003	<1.0	1.0
9.	Concentration of Particulate Matter	mg/Nm ³	IS 11255 (Part – 1) 1985 RA 2003 & ASTM D 3685/D 3685M-98 (reapproved 2005) : Sec. 11 (Vol. 3 11.07) : 2011	25.40	150.0

Remarks : Limit as per CPCB [Emission Regulation Part IV : COINDS/26/1986-87].
: N.A. means Not Available.

Reviewed By :

(Durbadal Chakraborty, Dy. Quality Manager)

Approved By :

(Dr. Ajoy Paul, Quality Manager)



ENVIROCHECK

Recognised by MoEF&CC, WBPCB & JSPCB
Accredited by NABL (ISO/IEC 17025:2017)
Certified by ISO 9001:2015, ISO 14001:2015 & ISO 45001 : 2018



TEST REPORT

FORMAT NO : ENV/FM/38

Name of the Project	:	Kolkata West International City Pvt. Ltd. (Project Name : Joyville)	Type of Project	:	Housing Complex
Address	:	Salap More, Howrah – Amta Road, Bombay Road Crossing, Howrah – 711403	Sampling Date	:	18.03.2021
			Period of Analysis	:	19.03.2021 – 20.03.2021
			Date of Issue	:	22.03.2021
Sampling Plan & Procedure	:	ENV/SOP/01	Deviation from the Sampling Method and Plan	:	No
			Type of Sample	:	Source Emission
Sample ID No.	:	262/EC/M/TR(A)/II	Report No.	:	262/EC/M/TR(A)/II/20-21

A. GENERAL INFORMATION ABOUT STACK PROVIDED BY THE INDUSTRY

Stack Attached to	:	D. G. – 125 KVA (Behind Sales Office) (Acoustic Enclosure)
Shape of Stack	:	Circular
Materials of Construction	:	M.S.
Capacity	:	125 KVA
Emission Due to	:	Combustion of H.S.D
Fuel Used	:	H.S.D
Working Fuel Consumption	:	12 liter./hr.
Pollution Control Device	:	Nil
Height of Stack (mtr.) (from G. L.)	:	3.0
Stack I.D. at sampling point (mtr.)	:	0.1016
Height of sampling port (mtr.) (from G.L.)	:	Final Exhaust
Permanent Platform & Ladder	:	No

B. RESULTS

SL. NO.	PARAMETERS	UNIT	METHOD NO.	RESULTS	LIMIT
1.	Flue Gas Temperature	°C	IS 11255 (Part 1)	58.0	N.A.
2.	Barometric Pressure	mm of Hg.	--	754.0	N.A.
3.	Velocity of Gas flow	m/s	IS 11255 (Part 3)	15.20	N.A.
4.	Quantity of Gas flow	Nm ³ /hr.	IS 11255 (Part III)	395.74	N.A.
5.	Concentration of SO ₂	mg/Nm ³	IS 11255 (Part 2) 1985 RA 2003	30.0	N.A.
6.	Concentration of NO _x	mg/Nm ³	IS : 11255 (Part 7) 2005 & ASTM D 1608-98 reapproved 2009 : Sec 11 (Vol. 11.07) : 2011	43.0	N.A.
7.	Concentration of CO ₂	% (v/v)	IS 13270 1992 RA 2003	6.4	N.A.
8.	Concentration of CO	% (v/v)	IS 13270 1992 RA 2003	<1.0	1.0
9.	Concentration of Particulate Matter	mg/Nm ³	IS 11255 (Part - 1) 1985 RA 2003 & ASTM D 3685/D 3685M-98 (reapproved 2005) : Sec. 11 (Vol. 3 11.07) : 2011	34.5	150.0

Remarks : Limit as per CPCB [Emission Regulation Part IV : COINDS/26/1986-87].
: N.A. means Not Available.

Reviewed By :

(Durbadal Chakraborty, Dy. Quality Manager)

Approved By :

(Dr. Ajoy Paul, Quality Manager)



ENVIROCHECK

Recognised by MoEF&CC, WBPCB & JSPCB
Accredited by NABL (ISO/IEC 17025:2017)
Certified by ISO 9001:2015, ISO 14001:2015 & ISO 45001 : 2018



TEST REPORT

FORMAT NO : ENV/FM/37

Name of the Project	:	Kolkata West International City Pvt. Ltd. (Project Name : Joyville)	Type of Project	:	Housing Complex
Address	:	Salap More, Howrah – Amta Road, Bombay Road Crossing, Howrah – 711403	Sampling Date	:	18.03.2021 – 19.03.2021
			Period of Analysis	:	19.03.2021 – 20.03.2021
			Date of Issue	:	22.03.2021
Sampling Plan & Procedure	:	ENV/SOP/01	Deviation from the Sampling Method and Plan	:	No
			Type of Sample	:	Source Emission
Sample ID No.	:	262/EC/M/TR(A)/III	Report No.	:	262/EC/M/TR(A)/III/20-21

A] GENERAL INFORMATION

1. Location of Sampling : Near Project Office
2. Duration of Sampling : 24 hrs. (09:00 a.m. – 09:00 a.m.)

B] METEOROLOGICAL INFORMATION

1. Average Temperature (°C) : 28.0
2. Average Relative Humidity (%) : 70.0
3. Barometric Pressure (mm of Hg) : 754.0
4. Smell or Odour : No Remarkable Smell
5. Weather Condition : Clear sky

C] RESULTS

SL. NO.	PARAMETERS	UNIT	METHOD NO.	RESULTS	LIMIT
1.	Concentration of PM _{2.5}	µg/m ³	USEPA 1997a, 40 CFR Part 50, Appendix L : 2006	32.5	60.0
2.	Concentration of PM ₁₀	µg/m ³	IS 5182 (PART 23) : 2006	68.2	100.0
3.	Concentration of SO ₂	µg/m ³	IS 5182 (Part 2) 2001 & ASTM D 2914-01 reapproved 2007: Sec. 11 (Vol. 11.07) : 2011	3.20	80.0
4.	Concentration of NO ₂	µg/m ³	IS 5182 (Part 6) 2006 & ASTM D 1607-91 reapproved 2005 : Sec 11 (Vol. 11.07) : 2011	21.0	80.0

Remarks : Limit as per National Ambient Air Quality Standards Central Pollution Control Board Notification, New Delhi, the 18th November, 2009.

Reviewed By :

(Durbadal Chakraborty, Dy. Quality Manager)

Approved By :

(Dr. Ajoy Paul, Quality Manager)



ENVIROCHECK

Recognised by MoEF&CC, WBPCB & JSPCB
Accredited by NABL (ISO/IEC 17025:2017)
Certified by ISO 9001:2015, ISO 14001:2015 & ISO 45001 : 2018



TEST REPORT

FORMAT NO : ENV/FM/37

Name of the Project	:	Kolkata West International City Pvt. Ltd. (Project Name : Joyville)	Type of Project	:	Housing Complex
Address	:	Salap More, Howrah – Amta Road, Bombay Road Crossing, Howrah – 711403	Sampling Date	:	15.09.2020 – 16.09.2020
			Period of Analysis	:	16.09.2020 – 18.09.2020
			Date of Issue	:	19.09.2020
Sampling Plan & Procedure	:	ENV/SOP/01	Deviation from the Sampling Method and Plan	:	No
			Type of Sample	:	Ambient Air
Sample ID No.	:	62/EC/M/TR(A)/IV	Report No.	:	62/EC/M/TR(A)/IV/20-21

A] GENERAL INFORMATION

1. Location of Sampling : Near Block No. A - 2
2. Duration of Sampling : 24 hrs. (11:40 a.m. – 11:40 a.m.)

B] METEOROLOGICAL INFORMATION

1. Average Temperature (°C) : 28.0
2. Average Relative Humidity (%) : 70.0
3. Barometric Pressure (mm of Hg) : 754.0
4. Smell or Odour : No Remarkable Smell
5. Weather Condition : Clear sky

C] RESULTS

SL. NO.	PARAMETERS	UNIT	METHOD NO.	RESULTS	LIMIT
1.	Concentration of PM _{2.5}	µg/m ³	USEPA 1997a, 40 CFR Part 50, Appendix L : 2006	33.50	60.0
2.	Concentration of PM ₁₀	µg/m ³	IS 5182 (PART 23) : 2006	71.20	100.0
3.	Concentration of SO ₂	µg/m ³	IS 5182 (Part 2) 2001 & ASTM D 2914-01 reapproved 2007: Sec. 11 (Vol. 11.07) : 2011	4.50	80.0
4.	Concentration of NO ₂	µg/m ³	IS 5182 (Part 6) 2006 & ASTM D 1607-91 reapproved 2005 : Sec 11 (Vol. 11.07) : 2011	23.10	80.0

Remarks : Limit as per National Ambient Air Quality Standards Central Pollution Control Board Notification, New Delhi, the 18th November, 2009.

Reviewed By :

(Durbadal Chakraborty, Dy. Quality Manager)

Approved By :

(Dr. Ajoy Paul, Quality Manager)



ENVIROCHECK

Recognised by MoEF&CC, WBPCB & JSPCB
Accredited by NABL (ISO/IEC 17025:2017)
Certified by ISO 9001:2015, ISO 14001:2015 & ISO 45001 : 2018



TEST REPORT

FORMAT NO : ENV/FM/37

Name of the Project	:	Kolkata West International City Pvt. Ltd. (Project Name : Joyville)	Type of Project	:	Housing Complex
Address	:	Salap More, Howrah – Amta Road, Bombay Road Crossing, Howrah – 711403	Sampling Date	:	15.09.2020 – 16.09.2020
			Period of Analysis	:	16.09.2020 – 18.09.2020
			Date of Issue	:	19.09.2020
Sampling Plan & Procedure	:	ENV/SOP/01	Deviation from the Sampling Method and Plan	:	No
			Type of Sample	:	Ambient Air
Sample ID No.	:	62/EC/M/TR(A)/V	Report No.	:	62/EC/M/TR(A)/V/20-21

A] GENERAL INFORMATION

1. Location of Sampling : Near Batching Plant
2. Duration of Sampling : 24 hrs. (10:50 a.m. – 10:50 a.m.)

B] METEOROLOGICAL INFORMATION

1. Average Temperature (°C) : 28.0
2. Average Relative Humidity (%) : 70.0
3. Barometric Pressure (mm of Hg) : 754.0
4. Smell or Odour : No Remarkable Smell
5. Weather Condition : Clear sky

C] RESULTS

SL. NO.	PARAMETERS	UNIT	METHOD NO.	RESULTS	LIMIT
1.	Concentration of PM _{2.5}	µg/m ³	USEPA 1997a, 40 CFR Part 50, Appendix L : 2006	50.20	60.0
2.	Concentration of PM ₁₀	µg/m ³	IS 5182 (PART 23) : 2006	87.30	100.0
3.	Concentration of SO ₂	µg/m ³	IS 5182 (Part 2) 2001 & ASTM D 2914-01 reapproved 2007: Sec. 11 (Vol. 11.07) : 2011	6.90	80.0
4.	Concentration of NO ₂	µg/m ³	IS 5182 (Part 6) 2006 & ASTM D 1607-91 reapproved 2005 : Sec 11 (Vol. 11.07) : 2011	25.20	80.0

Remarks : Limit as per National Ambient Air Quality Standards Central Pollution Control Board Notification, New Delhi, the 18th November, 2009.

Reviewed By :

(Durbadal Chakraborty, Dy. Quality Manager)

Approved By :

(Dr. Ajoy Paul, Quality Manager)



ENVIROCHECK

Recognised by MoEF&CC, WBPCB & JSPCB
Accredited by NABL (ISO/IEC 17025:2017)
Certified by ISO 9001:2015, ISO 14001:2015 & ISO 45001 : 2018



TEST REPORT

FORMAT NO : ENV/FM/37

Name of the Project	:	Kolkata West International City Pvt. Ltd. (Project Name : Joyville)	Type of Project	:	Housing Complex
Address	:	Salap More, Howrah – Amta Road, Bombay Road Crossing, Howrah – 711403	Sampling Date	:	15.09.2020 – 16.09.2020
			Period of Analysis	:	16.09.2020 – 18.09.2020
			Date of Issue	:	19.09.2020
Sampling Plan & Procedure	:	ENV/SOP/01	Deviation from the Sampling Method and Plan	:	No
			Type of Sample	:	Ambient Air
Sample ID No.	:	62/EC/M/TR(A)/VI	Report No.	:	62/EC/M/TR(A)/VI/20-21

A] GENERAL INFORMATION

1. Location of Sampling : Near Block No. B-6
2. Duration of Sampling : 24 hrs. (11:20 a.m. – 11:20 a.m.)

B] METEOROLOGICAL INFORMATION

1. Average Temperature (°C) : 28.0
2. Average Relative Humidity (%) : 70.0
3. Barometric Pressure (mm of Hg) : 754.0
4. Smell or Odour : No Remarkable Smell
5. Weather Condition : Clear sky

C] RESULTS

SL. NO.	PARAMETERS	UNIT	METHOD NO.	RESULTS	LIMIT
1.	Concentration of PM _{2.5}	µg/m ³	USEPA 1997a, 40 CFR Part 50, Appendix L : 2006	33.50	60.0
2.	Concentration of PM ₁₀	µg/m ³	IS 5182 (PART 23) : 2006	74.90	100.0
3.	Concentration of SO ₂	µg/m ³	IS 5182 (Part 2) 2001 & ASTM D 2914-01 reapproved 2007: Sec. 11 (Vol. 11.07) : 2011	7.50	80.0
4.	Concentration of NO ₂	µg/m ³	IS 5182 (Part 6) 2006 & ASTM D 1607-91 reapproved 2005 : Sec 11 (Vol. 11.07) : 2011	20.50	80.0

Remarks : Limit as per National Ambient Air Quality Standards Central Pollution Control Board Notification, New Delhi, the 18th November, 2009.

Reviewed By :

(Durbadal Chakraborty, Dy. Quality Manager)

Approved By :

(Dr. Ajoy Paul, Quality Manager)



ENVIROCHECK

Recognised by MoEF&CC, WBPCB & JSPCB
Accredited by NABL (ISO/IEC 17025:2017)
Certified by ISO 9001:2015, ISO 14001:2015 & ISO 45001 : 2018



FORMAT NO. ENV/FM/40

TEST REPORT

Name of the Project	:	Kolkata West International City Pvt. Ltd. (Project Name : Joyville)	Type of Project	:	Housing Complex
Project Site Address	:	Salap More, Howrah – Amta Road, Bombay Road Crossing, Howrah – 711403	Sampling Date	:	18.03.2021
			Period of Analysis	:	18.03.2021 – 23.03.2021
			Date of Issue	:	25.03.2021
Sampling Plan & Procedure	:	ENV/SOP/01	Deviation from the Sampling Method and Plan	:	No
			Type of Sample	:	Effluent Water
Location	:	Labour Camp (Site)	Sample ID No.	:	ENV/753/W/M/I
			Report No.	:	ENV/753/W/M/I/20-21

SL. NO.	PARAMETERS	TEST METHOD	UNIT	RESULTS	LIMIT
1.	pH value	4500 H+B APHA 23 rd Edition, 2017	-	6.50	5.5-9.0
2.	Total Suspended Solids	2540 D APHA 23 rd Edition, 2017	mg/l	29.0	100.0
3.	Oil & Grease	5520 Oil B/D APHA 23 rd Edition, 2017	mg/l	3.2	10.0
4.	Chemical Oxygen Demand	5200 COD B/C/D APHA 23 rd Edition, 2017	mg/l	85.0	250.0
5.	Biochemical Oxygen Demand for 3 days at 27°C	5210 BOD B APHA 23 rd Edition, 2017	mg/l	24.0	30.0

Reviewed By :

(Durbadal Chakraborty, Dy. Quality Manager)

Approved By :

(Dr. Ajoy Paul, Quality Manager)



ENVIROCHECK

Recognised by MoEF&CC, WBPCB & JSPCB
Accredited by NABL (ISO/IEC 17025:2017)
Certified by ISO 9001:2015, ISO 14001:2015 & ISO 45001 : 2018



Certificate No. TC-6014



ACCREDITED
Management Systems
Certification Body
MSCB-150
ISO 14001:2015

ACCREDITED
Management Systems
Certification Body
MSCB-150
ISO 45001:2018

FORMAT NO. ENV/FM/40

TEST REPORT

Name of the Project	:	Kolkata West International City Pvt. Ltd. (Project Name : Joyville)	Type of Project	:	Housing Complex
Project Site Address	:	Salap More, Howrah – Amta Road, Bombay Road Crossing, Howrah – 711403	Sampling Date	:	18.03.2021
			Period of Analysis	:	18.03.2021 – 23.03.2021
			Date of Issue	:	25.03.2021
Sampling Plan & Procedure	:	ENV/SOP/01	Deviation from the Sampling Method and Plan	:	No
			Type of Sample	:	Effluent Water
Location	:	Labour Camp (Batching Plant)	Sample ID No.	:	ENV/499/W/M/II
			Report No.	:	ENV/499/W/M/II/20-21

SL. NO.	PARAMETERS	TEST METHOD	UNIT	RESULTS	LIMIT
1.	pH value	4500 H+B APHA 23 rd Edition, 2017	-	7.50	5.5-9.0
2.	Total Suspended Solids	2540 D APHA 23 rd Edition, 2017	mg/l	42.0	100.0
3.	Oil & Grease	5520 Oil B/D APHA 23 rd Edition, 2017	mg/l	2.5	10.0
4.	Chemical Oxygen Demand	5200 COD B/C/D APHA 23 rd Edition, 2017	mg/l	75.0	250.0
5.	Biochemical Oxygen Demand for 3 days at 27°C	5210 BOD B APHA 23 rd Edition, 2017	mg/l	22.0	30.0

Reviewed By :

(Durbadal Chakraborty, Dy. Quality Manager)

Approved By :

(Dr. Ajoy Paul, Quality Manager)



ENVIROCHECK

Recognised by MoEF&CC, WBPCB & JSPCB
Accredited by NABL (ISO/IEC 17025:2017)
Certified by ISO 9001:2015, ISO 14001:2015 & ISO 45001 : 2018



FORMAT NO. ENV/FM/40

TEST REPORT

Name of the Project	:	Kolkata West International City Pvt. Ltd. (Project Name : Joyville)	Type of Project	:	Housing Complex
Project Site Address	:	Salap More, Howrah – Amta Road, Bombay Road Crossing, Howrah – 711403	Sampling Date	:	18.03.2021
			Period of Analysis	:	18.03.2021 – 23.03.2021
			Date of Issue	:	25.03.2021
Sampling Plan & Procedure	:	ENV/SOP/01	Deviation from the Sampling Method and Plan	:	No
			Type of Sample	:	Effluent Water
Location	:	Labour Colony Outlet	Sample ID No.	:	ENV/499/W/M/III
			Report No.	:	ENV/499/W/M/III/20-21

SL. NO.	PARAMETERS	TEST METHOD	UNIT	RESULTS	LIMIT
1.	pH value	4500 H+B APHA 23 rd Edition, 2017	-	7.10	5.5-9.0
2.	Total Suspended Solids	2540 D APHA 23 rd Edition, 2017	mg/l	22.0	100.0
3.	Oil & Grease	5520 Oil B/D APHA 23 rd Edition, 2017	mg/l	3.5	10.0
4.	Chemical Oxygen Demand	5200 COD B/C/D APHA 23 rd Edition, 2017	mg/l	45.0	250.0
5.	Biochemical Oxygen Demand for 3 days at 27°C	5210 BOD B APHA 23 rd Edition, 2017	mg/l	15.0	30.0

Reviewed By :

(Durbadal Chakraborty, Dy. Quality Manager)

Approved By :

(Dr. Ajoy Paul, Quality Manager)



ENVIROCHECK

Recognised by MoEF&CC, WBPCB & JSPCB
Accredited by NABL (ISO/IEC 17025:2017)
Certified by ISO 9001:2015, ISO 14001:2015 & ISO 45001 : 2018



FORMAT NO. : ENV/FM/56

TEST REPORT

1.	Name of the Project	:	Kolkata West International City Pvt. Ltd. (Project Name : Joyville)
2.	Address	:	Salap More, Amta Road, Bombay Road Crossing, District - Howrah, Pin - 711403
3.	Type of Industry	:	Housing Project
4.	Sampling Plan & Procedure	:	ENV/SOP/01
5.	Deviation from the Sampling Method & Plan	:	No
6.	Sample ID No	:	236/EC/M/N/20-21
7.	Date of Study	:	18/03/2021
8.	Reporting Date	:	05/04/2021
9.	Method No.	:	IS: 9989 - 1981
10.	Time of Duration of Noise	:	20 Minutes
11.	Height from Ground Level	:	4 feet

RESULT OF NOISE LEVEL STUDY

DAY TIME

1. Location of Study : Near Project Office				
Time (A.M)	Minimum dB(A)	Maximum dB(A)	Leq dB(A)	
11:00 – 11:20	59.6	68.9	66.37	

NIGHT TIME

2. Location of Study : Near Project Office				
Time (P.M)	Minimum dB(A)	Maximum dB(A)	Leq dB(A)	
10:00 - 10:20	49.4	56.2	54.01	

DAY TIME

3. Location of Study : Near Block No. A - 2				
Time (A.M)	Minimum dB(A)	Maximum dB(A)	Leq dB(A)	
11:30 – 11:50	60.5	66.8	64.70	

NIGHT TIME

4. Location of Study : Near Block No. A - 2				
Time (P.M)	Minimum dB(A)	Maximum dB(A)	Leq dB(A)	
10:30 - 10:50	47.1	54.8	52.47	

** Mean of Leq - Equivalent to Sound Energy

Limit in Leq dB(A)

Category Area	Day Time dB(A)	Night Time dB(A)
A. Industrial Area	75	70
B. Commercial Area	65	55
C. Residential Area	55	45
D. Silence Zone	50	40
**Day Time is reckoned in between 6:00 A.M & 10:00 P.M		**Night Time is reckoned in between 10:00 P.M & 6:00 A.M
(Central Pollution Control Board, Ministry of Environment & Forests Government of India) & (Department of Environment, Government of West Bengal)		

Continued page - 2



ENVIROCHECK

Recognised by MoEF&CC, WBPCB & JSPCB

Accredited by NABL (ISO/IEC 17025:2017)

Certified by ISO 9001:2015, ISO 14001:2015 & ISO 45001 : 2018



PERMISSIBLE NOISE EXPOSURE FOR INDUSTRIAL WORKERS

Hours	Limit in dB(A)
8	90
4	93
2	96
1	99
1/2	102
1/4	105
1/8	108
1/16	111
1/32	114
(2 minutes or less)	-

** The Noise Pollution (Regulation and Control Rules, 2000
** S.O. 123 (E) Dated : 14th February, 2000

Reviewed By:

Dy. Quality Manager

Approved By:

Quality Manager

>End of Report<

GRAPHICAL PRESENTATIONS

Compliance Period : October 20 – March 21

Stack Emission Monitoring Data

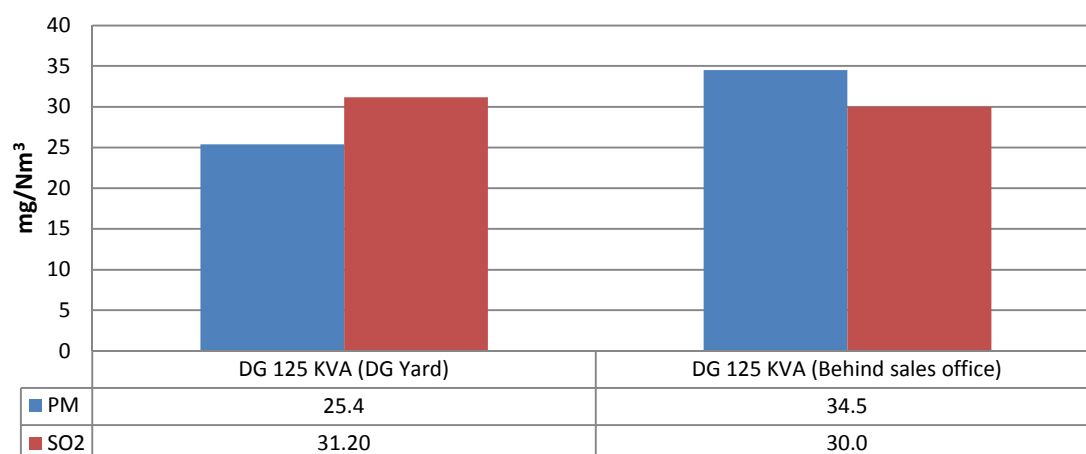

Ambient Air Quality Monitoring Data

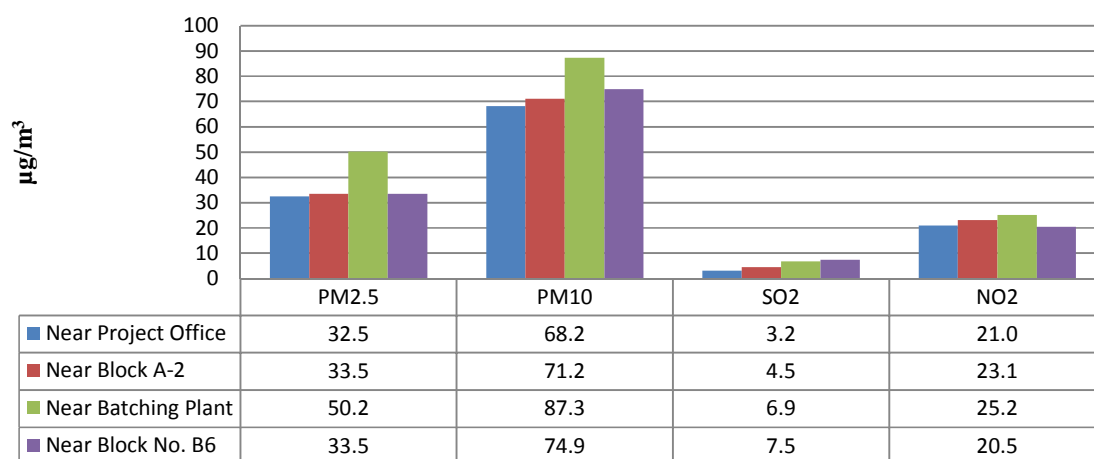

NOISE LEVEL DATA

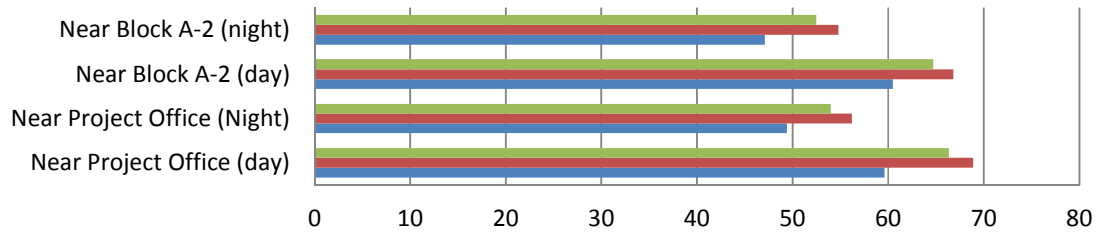

	Near Project Office (day)	Near Project Office (Night)	Near Block A-2 (day)	Near Block A-2 (night)
■ Leq	66.37	54.01	64.70	52.47
■ Max	68.9	56.2	66.8	54.8
■ Min	59.6	49.4	60.5	47.1

GRAHICAL PRESENTATION

APRIL 2020 TO SEPTEMBER 2020

Stack Emission Monitoring Data

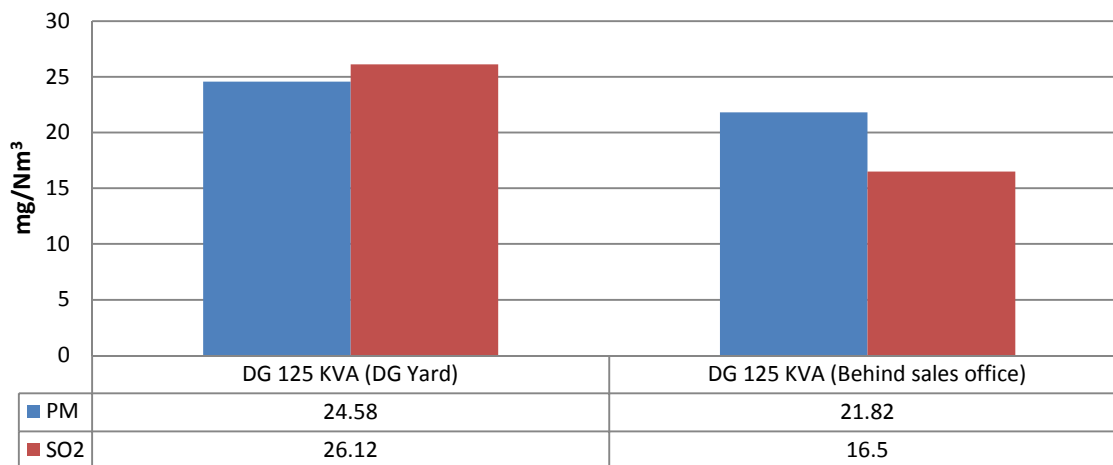

Ambient Air Quality Monitoring Data

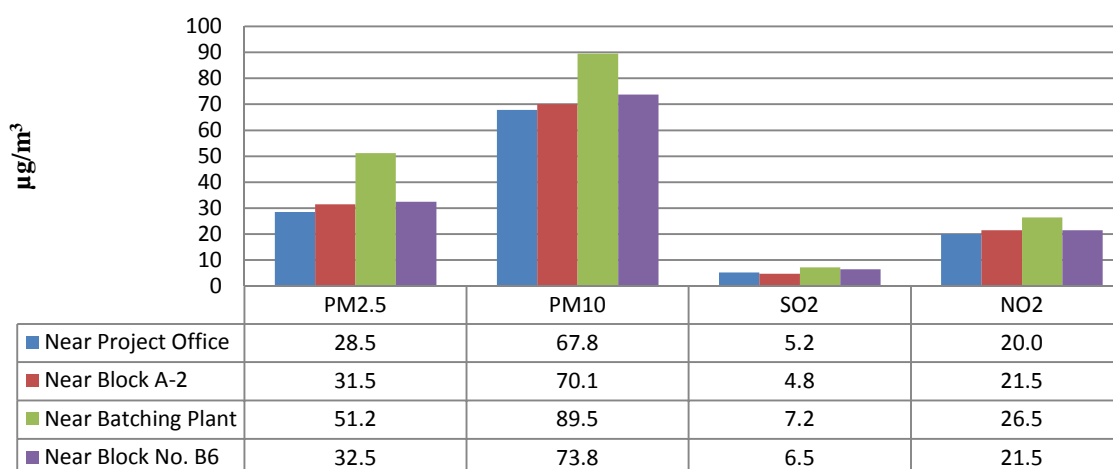

NOISE LEVEL DATA

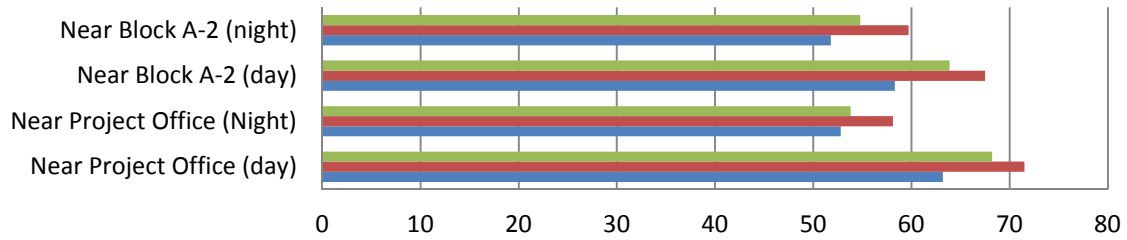

	Near Project Office (day)	Near Project Office (Night)	Near Block A-2 (day)	Near Block A-2 (night)
■ Leq	68.23	53.82	63.89	54.78
■ Max	71.5	58.1	67.5	59.7
■ Min	63.2	52.8	58.3	51.8

GRAPHICAL PRESENTATION

October 2019 to March 2020

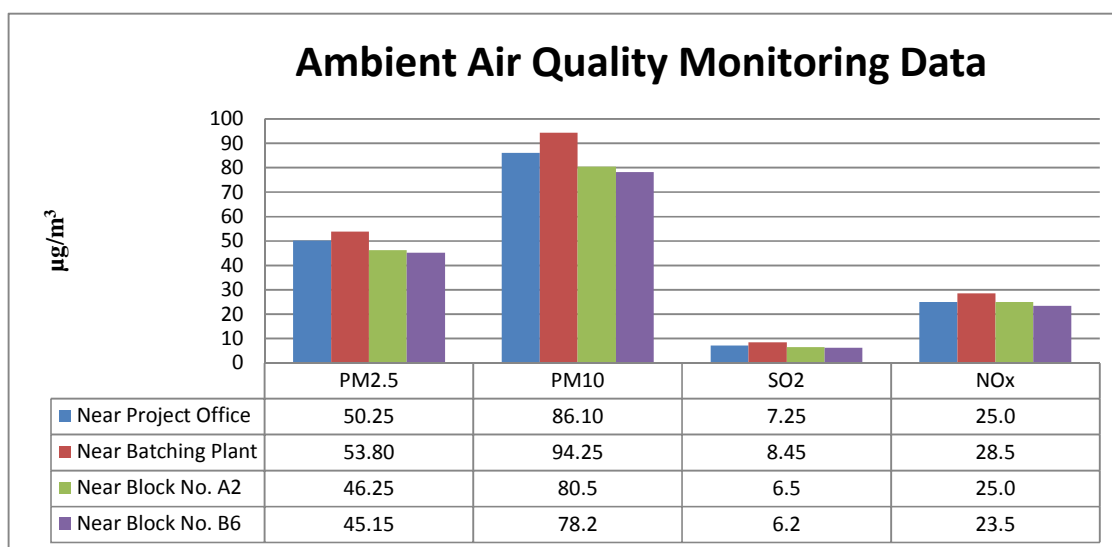
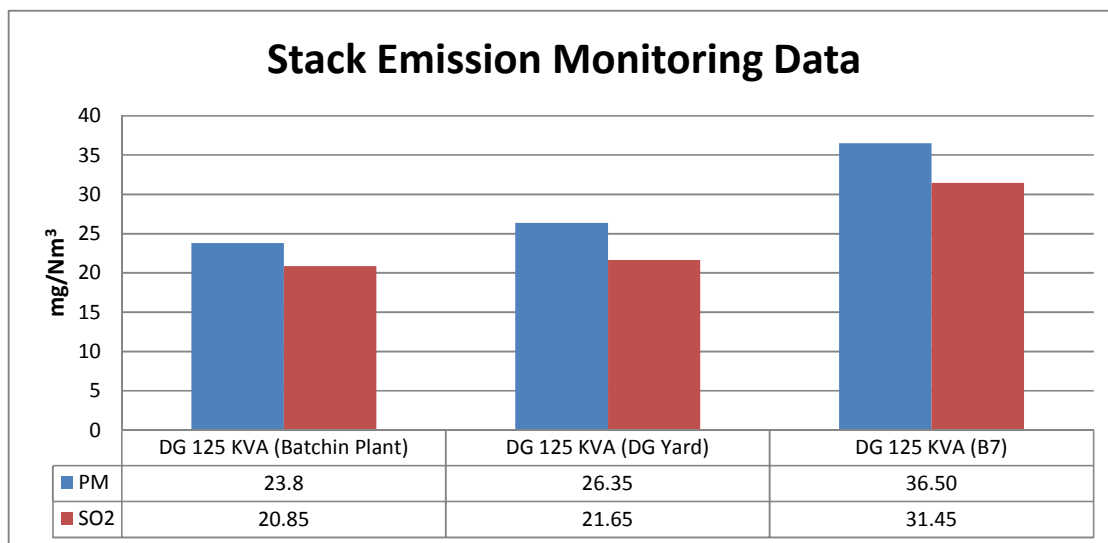

GRAPHICAL PRESENTATION

April 2019 to September 2019

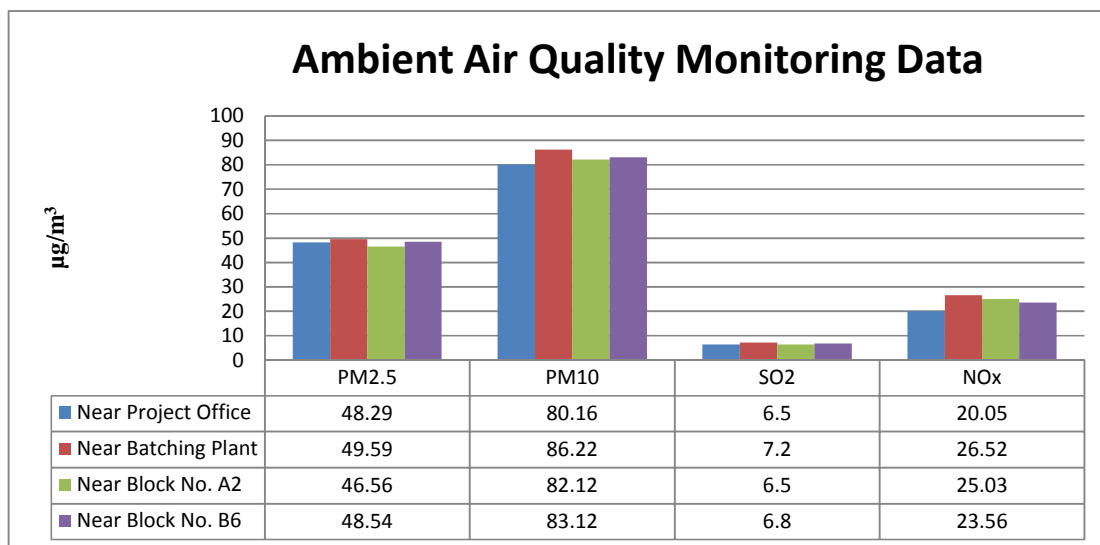
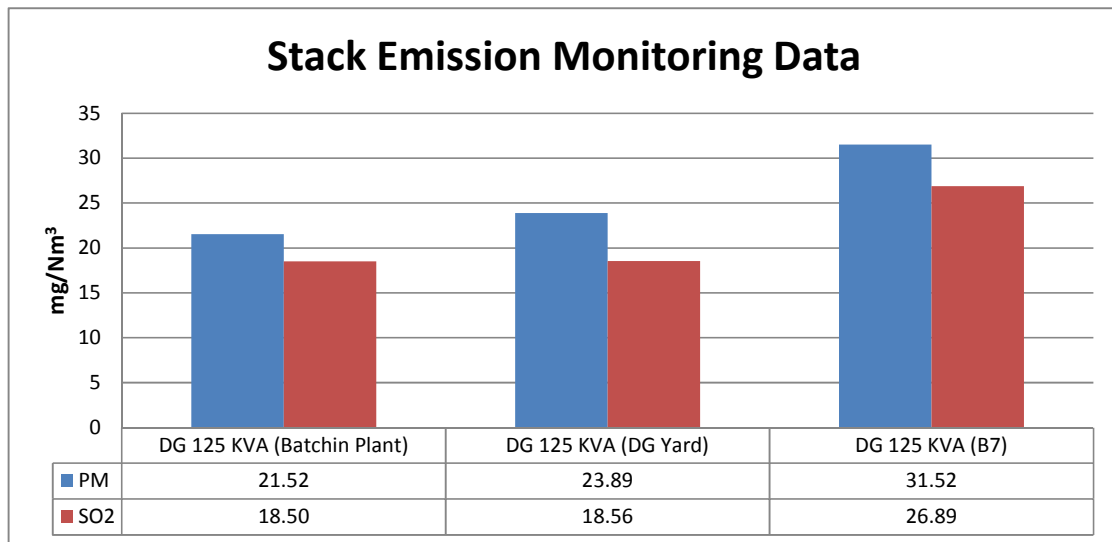

MONITORING PHOTOGRAPHS

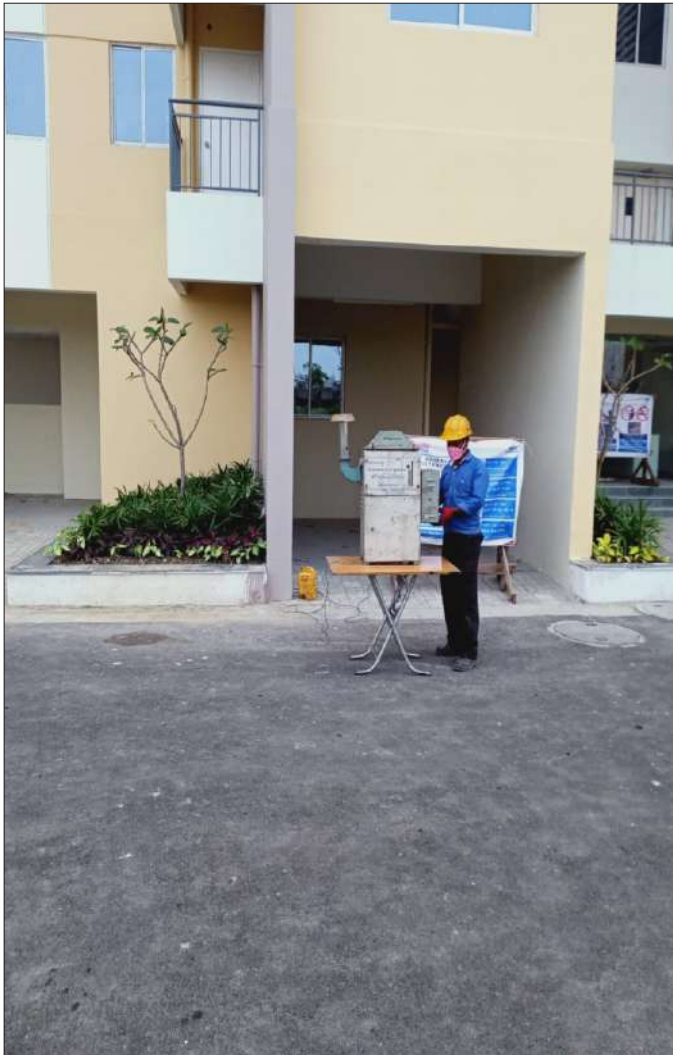





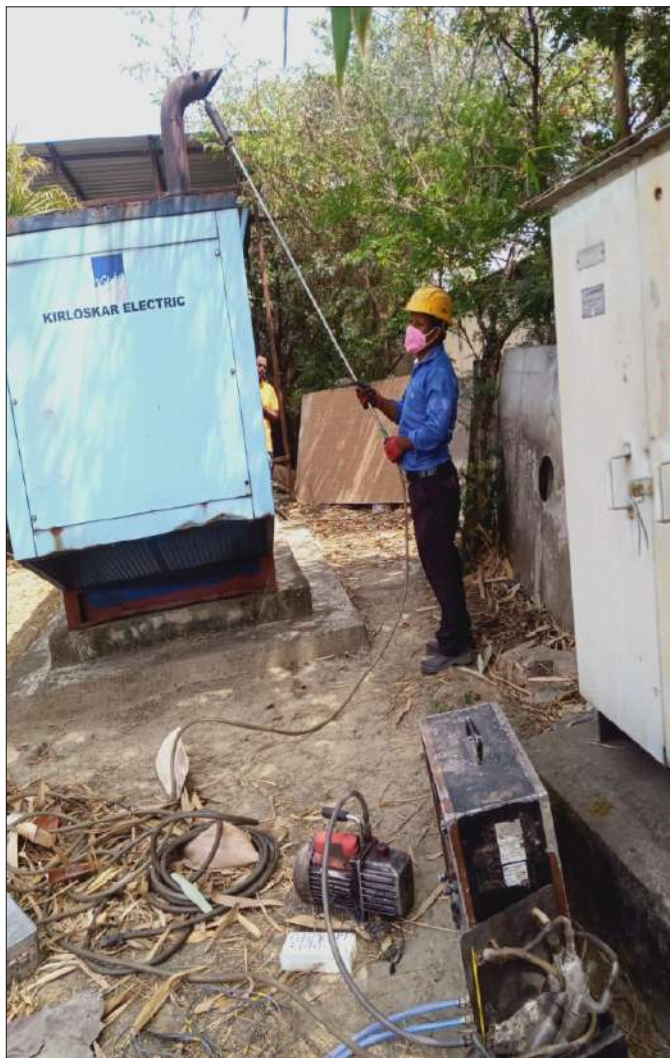

Water Balance Diagram

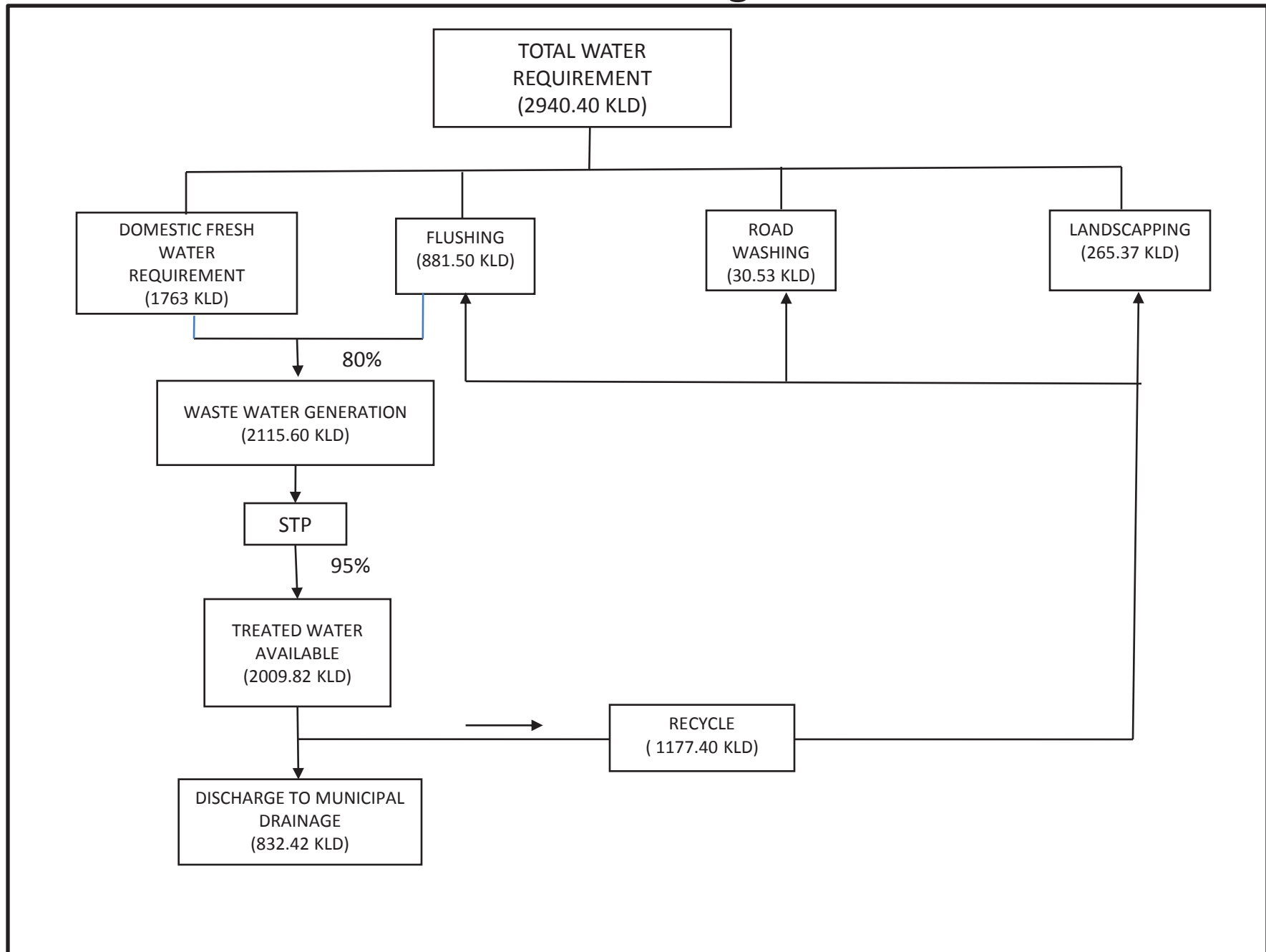

STP DETAILS

ANNEXURE- 5

DESIGN PARAMETERS

- MCRT FOR BIOREACTOR – 20 HOURS
- HRT FOR SECONDARY CLARIFIER – 4 HOURS
- F/M RATIO – 0.2
- EFFLUENT BOD - <10 mg/l

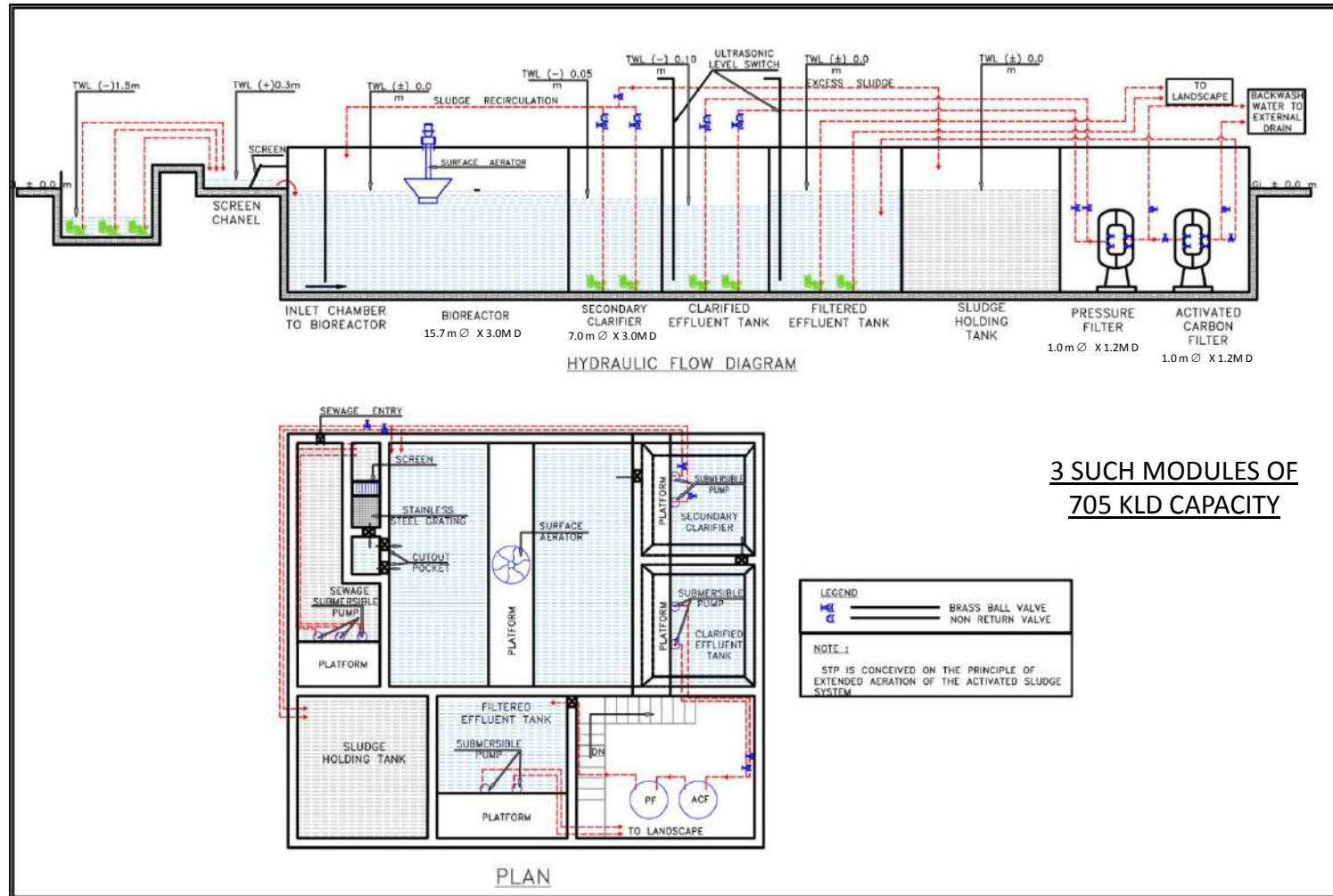

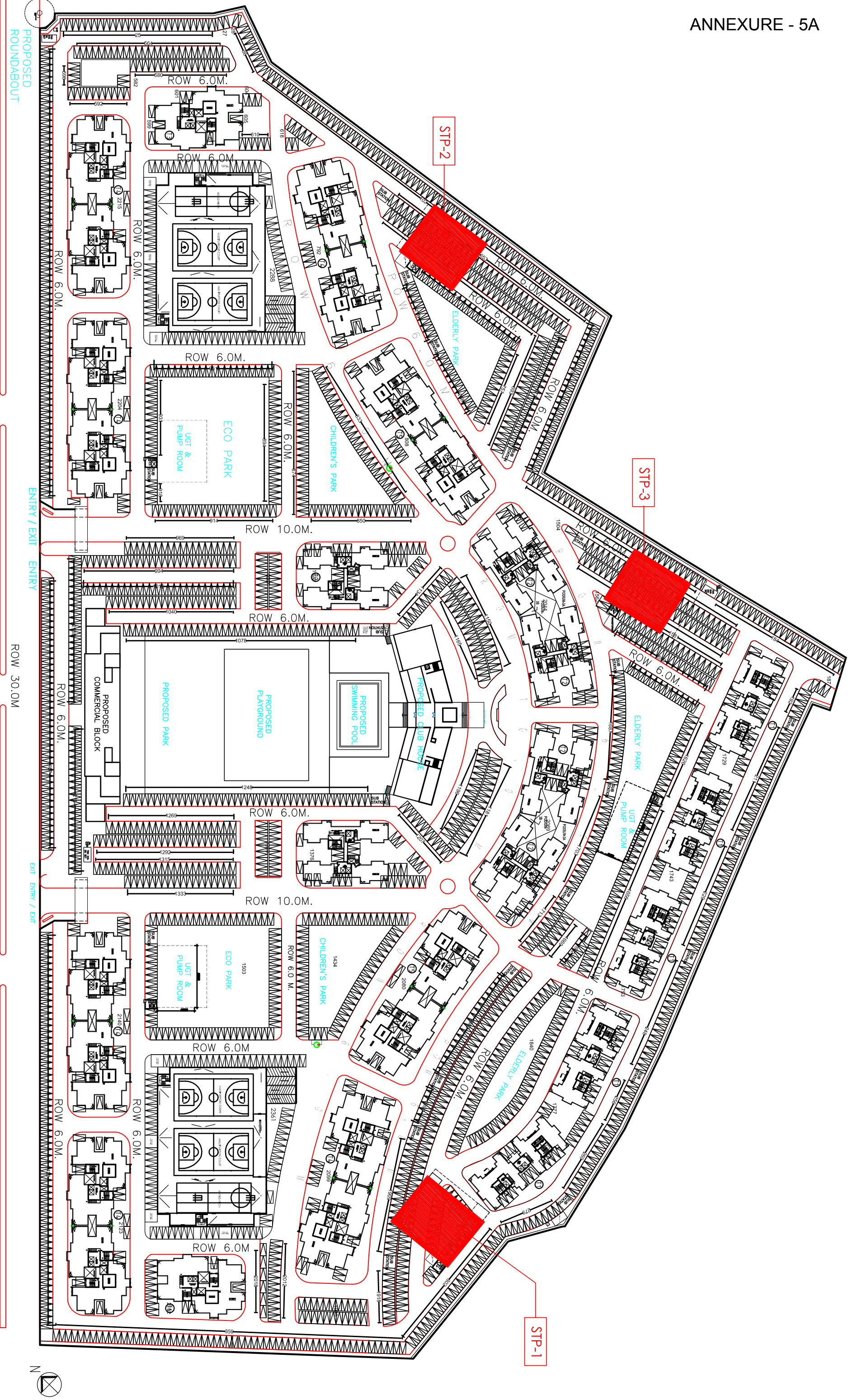

PROPOSED LOCATION OF THE STP MARKED HATCHED IN RED FOR PROJECT - PH-2B, KWIC-HOWRAH.

PROPOSED RAIN WATER HARVESTING DETAILS

Rainwater Water Harvesting details for Environmental Clearance of Phase-2B of KWICat Domjur, District Howrah

Theoretical Collection Efficiency						
Sl. No.	Description	Area (sqm)	Co-efficient of Runoff	Intensity of Rainfall (mm/hr)	Duration of peak storm (hr)	Discharge (cum)
1.	Roof Area	17440	0.85	62	0.25	229.77

Considering collection efficiency of 80%, total required volume = 183.82 cum

100% of the total required volume i.e. 183.82 cum is proposed to be provided in surface storage (in rainwater harvesting tanks).

Since individual rainwater harvesting tanks will be required as per (i) availability of land, (ii) drainage system designed and (iii) proposed land use, 3 nos. tanks of various sizes is proposed at different locations of the project.

The Tank sizes proposed are :

1. 6m x 6m x 2m = 72 cum
2. 6m x 6m x 2m = 72 cum
3. 6m x 6m x 2m = 72 cum

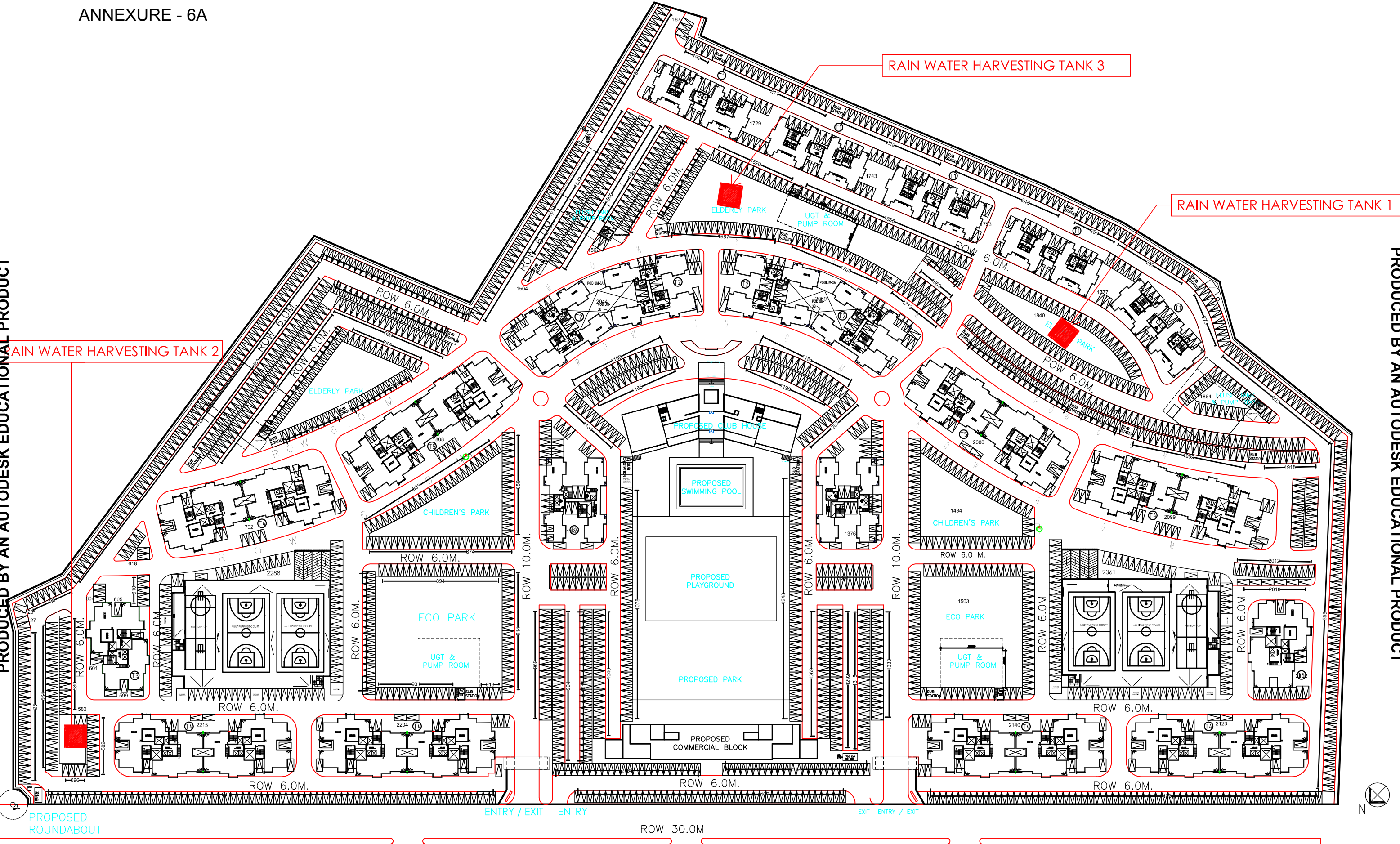

PROPOSED LOCATION OF THE RAIN WATER HARVESTING TANK MARKED HATCHED IN RED FOR PROJECT - PH-2B, KWIC, HOWRAH.

PROPOSED SOLID WASTE MANAGEMENT DETAILS

Solid Waste Management details for Environmental Clearance of Phase-2B of KWIC at Domjur, District Howrah

- Fixed population = 17120 nos
- Solid waste generation = 17120×600 gms/day
= 10272 Kg/day
= 10.272 T/day
- Floating population = 1700 nos
- Solid waste generation = 1700×150 gms/day
= 255 Kg/day
= 0.255 T/day
- Total solid waste generation = $(10.272 + 0.255)$ T/day
= 10.527 T/day
~ 10.5 T/day
- Biodegradable fraction = 40% of total solid waste generation
= 4.2 T/day
- Mechanically composted inside the site -
 - Area required – 40 sqm
 - Area provided - 45sqm (3 nos @ 15 sqm each as per attachment)
- Recyclable fraction to be disposed through Howrah Municipal Corporation
- Inorganic inert fraction also to be disposed through Howrah Municipal Corporation

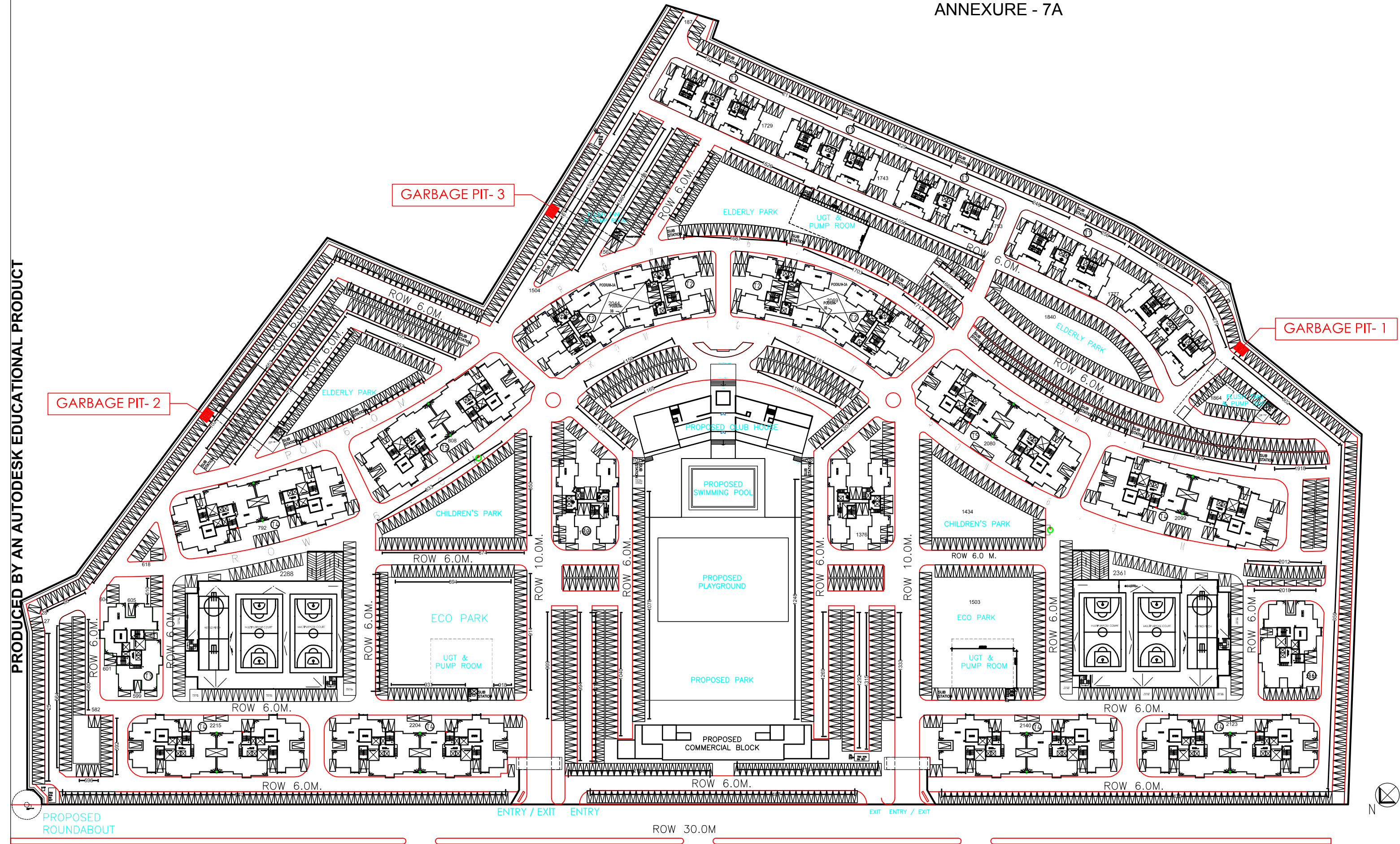

PROPOSED LOCATION OF THE GARBAGE PIT MARKED HATCHED IN RED FOR PROJECT - PH-2B, KWIC-HOWRAH.



Long queue in front of a bank in Kolkata on Friday. ■ Biswajit Ghoshal

Sanctions over ₹6 crore to weavers' cooperatives

After getting the letter, very quickly she sanctioned the amount. We have received the entire amount and already a major portion of it has been disbursed.

AN OFFICIAL

man today, Debnath said that he has already sent a fresh letter to the Union textile minister seeking sanction and release of the marketing incentive amounting to Rs 5 crore 85 lakhs of the fiscal 2012-2013, but has been long due.

"I have just received the letter from Smriti Irani ji that she has received the letter sent by me. Hopefully the old amount will be released now," he added.

For delayed submission by the state government at

that time, the amount could not be sanctioned, sources said.

There are about 2000 weavers' cooperatives in the state, but only 500 have been functioning at present. The West Bengal State Handloom Weavers' Cooperative Society Limited, Tantuja, is the apex body of the primary weavers' cooperative societies of the state, and is mainly responsible for supply of inputs and marketing of Handloom products of primary societies.

The apex society is also engaged in organising and developing markets for handloom products within the state and outside. To establish and run sale depots within and outside the state for sale of handloom goods, the society needs adequate working capital. The state government contributes to

the share capital of the apex society for strengthening its share capital base.

Each of the 500 weavers' cooperatives have 400 to 500 members. There are about several thousands of weavers registered under these cooperatives.

At present, like all other small and micro industries, the weavers' cooperatives of the state have also been affected.

A meeting has been held today at Khadi Bhawan, where besides minister, Debnath officials of the weavers' cooperatives, MD of Tantuja Rabinranath Roy, director of textiles (handloom, spinning mills, silk weaving and handloom based handicrafts) Debashish Ghosh and other top officials were present. The present scenario have been discussed in the meeting, sources said.

State BJP leaders protest against child trafficking

STATESMAN NEWS SERVICE

Kolkata, 2 December

State BJP leaders and supporters today launched an agitation against child trafficking and burnt the effigy of chief minister Mamata Banerjee demanding her resignation.

Actor and senior BJP leader Jay Banerjee, who is also associated with the medical and welfare cell of the BJP said that Miss Banerjee and minister of state for women & social welfare and child development Dr Shashi Panja must submit their resignation immediately as large number of infants were trafficked to other states of India and abroad by child traffickers after stealing the newborn babies from their mothers' custody. "State government could not bypass its responsibility regarding the pres-

ence of this massive state-wise racket. I have been flooded with calls from my NRI friends and fans from abroad as they expressed their concern regarding this matter," said Mr Banerjee.

BJP president Mr Dilip Ghosh and general secretary Debashree Chowdhury attended the rally.

A procession was organised from WIPRO More to Swasthya Bhavan to protest against baby trafficking. On being asked if Dr Dilip Ghosh who contested the Assembly polls on a BJP ticket was involved in the child trafficking racket, president Mr Ghosh said that the state BJP soon expelled him and he has to prove himself clean if he again wants to join the party. "We suspended him from all posts, but Ttinaamul did not suspend any minister, MLA or MP involved in the Saradha scam."

FOREST OFFICIALS TO PUSH AWAY TUSKERS crops under threat

more than 200 hectare area and more than 200 human settlements. Mr Sarkar held a meeting recently on this issue.

"At least 10 gram panchayat areas under Matigara, Naxalbari and Phansidewa blocks have been affected. We are concerned with the situation," Sarkar said.

There are four elephant squads operational under the division.

"One squad involves the local people. The local people have been engaged because we are reeling under staff crisis. We have provided them

sound crackers, search lights and other necessary materials to prevent the elephants from damaging the huts, crops," Sherpa added.

The forest department had raised objections on the Nepal government's fencing move and had written to the Centre on this issue, urging them to take the matter up with the Nepal government.

Indian and Nepal share porous borders and there is no restriction on the movement on the people of both countries.

The elephants would often raid dwellings and

crops on both the sides. Drawn by ripe corn in the fields, Indian elephants would cross over to Nepal. Lives of several elephants and people were lost in the process. Thus elephants from the Indian side are not welcome in Nepal. The conflict has caused irreparable loss to both sides.

According to the animal lovers, it is the need of the hour to start the recruitment drive of the forest department and that the Centre should raise the issue of electric fencing with the Nepal government.

NOTICE

This is to inform all concerned that State Level Environment Impact Assessment Authority (Dept of Environment), Govt. of West Bengal, vide its letter **No. 2237/EN/T-II-1/126/2008 (Pt-1)** dated 04.10.2016 has accorded environmental clearance for **Phase-2B** of the proposed Township project by M/s. Kolkata West International City Pvt. Ltd. at Mouja Kona, Baltikuri, Bankra, Pakuria, Tentulkuli, Khalia and Salap, P.O. & P.S. Domjur, Dist. Howrah, West Bengal. Copy of the Environmental Clearance is available with the office of West Bengal Pollution Control Board, Kolkata.

M/s. Kolkata West International City Pvt. Ltd.
Vichitra, Kolkata West International City, Salap Junction
Howrah-Amta Road & Bombay Road Crossing;
NH-6 Howrah - 711 403.

মাঠে হারানোর পরে বিক্রেতা খেলার আগেই বার্ষিক কোচিং সিস্টেম দিয়েছিলেন ইনিয়ন্ত্রণের মাঠে ফেরার কথা। শুক্রবার এক বিবৃতি দিয়ে বার্ষিক জানিয়ে দেয়, শনিবারই মহারণে মাঠে নামতে চলেছেন ইনিয়ন্ত্রণ। মাকমাঠে তাঁর সঙ্গে থাকবেন ইভান রাকিটিচ এবং সের্জিও বাসকোয়েটস। আক্রমণভাগে মেনি, নেইমার এবং সুয়ারেজ থাকলেও সাম্প্রতিক অনেক ম্যাচেই দেখা গেছে, মাকমাঠ থেকে বল সাপ্লাই বন্ধ হয়ে যাওয়ার কারণে বিশেষ সুবিধে করতে পারছেন না বার্ষিকের বিশ্বখ্যাত ত্রয়ী। এবার ইনিয়ন্ত্রণ ফেরায় চিন্তা কিছুটা হলেও কমবে



সাংবাদিক সম্মেলনে এনরিকে।

এনরিকোর। তবে এতদিন পর মাঠে ফিরে ইনিয়ন্ত্রণ নিজেকে কতটা মেলে ধরতে পারবেন, সেই প্রশ্নও থাকছে। শুক্রবার সাংবাদিক সম্মেলনে এনরিকে জানান, রিয়েল ম্যাচে শুরু

বলেছেন, 'সন্দেহ নেই, আমাদের বিপক্ষ খুবই শক্তিশালী। এইমুহুর্তে আমাদের খারাবাহিকতাও কম। কিন্তু ওসব নিয়ে ভাবছিই না। এখনও অনেক খেলা বাকি। নিশ্চয়ই আমরা ঘুরে দাঁড়াব।' একটু থেমেই জুড়ে দিয়েছেন বার্ষিক কোচ, 'কাল আমাদের লক্ষ্যই হবে, আক্রমণের খাঁজ বাড়ানো, বল পজেশন নিজদের দখলে রাখা। আসলে এটাই আমাদের নীতি, তার থেকে সরে আসছি না।' কোনও চাপ অনুভব করছেন? এনরিকের উত্তর, 'এটা তো আমার প্রথম এল ক্লাসিকো নয়। প্লেয়ার হিসেবে, কোচ হিসেবেও আগে এল ক্লাসিকো খেলার

আমরা হারানোর পরেই পড়ব। এইভাবেই নিজদের তাতাচ্ছেন বার্ষিক ফুটবলাররা। ইনিয়ন্ত্রণ ফেরায় মানোবল যেমন বেড়েছে, তেমনই দিনের শেষে সবথেকে বড় ভরসা সেই ত্রয়ী— এম এন এস। নিজেকে দিনে ওঁরাই পার্থক্য গড়ে দিতে জানেন পারেনও। আর বিপক্ষ শিবিরে রোনাল্ডো মতো ফুটবলার থাকলে মেনি, নেইমার সুয়ারেজেরা আরও জ্বলে উঠতে চাইবেন। আজ রাতে ওঁদের মধ্যে এই আগুনটাই দেখতে চাইছেন কোচ এনরিকে থেকে 'তামা' সমর্থক ANNEXURE - 8A

সেরা র‍্যাঙ্কিং! সিন্ধু ৭

মুম্বই, ২ ডিসেম্বর— দু'ধাপ এগিয়ে কেরিয়ারের সেরা র‍্যাঙ্কিংয়ে পি ভি সিন্ধু। ব্যাডমিন্টন ওয়ার্ল্ড ফেডারেশনের প্রকাশিত মহিলাদের সিঙ্গেলস র‍্যাঙ্কিংয়ে সাত নম্বরে সিন্ধু। এক ধাপ উঠে দশ নম্বরে সাইনা। চীন ওপেনের পর হংকং ওপেনের সুপার সিরিজে দুর্দান্ত পারফরমেন্সের সুবাদেই সিন্ধুর এই উন্নতি। র‍্যাঙ্কিংয়ে প্রথম সাতের চুকে পড়ার পাশাপাশি আসন্ন ব্যাডমিন্টন ওয়ার্ল্ড ফেডারেশন সুপার সিরিজের ফাইনালেও জায়গা পাকা করে নিলেন এই ভারতীয় তারকা। র‍্যাঙ্কিংয়ে উন্নতি হংকং ওপেনের রানার্স ভারতীয় ব্যাডমিন্টনের নতুন আবিষ্কার সমীর ভর্মার। ১৩ ধাপ উঠে ৩০ নম্বরে সমীর। একধাপ করে নেমেছেন কিদাম্বী শ্রীকান্ত (১৩) ও অজয় জয়রাম (১৯)।



বর্ষসেরা দেবশ্রী



আজকালের প্রতিবেদন: বাংলার বর্ষসেরা অ্যাথলেটিক দেবশ্রী মজুমদার। অ্যাথলেটিক কোচেস অ্যাসোসিয়েশন অফ বেঙ্গলের বিচারে। দেবশ্রীকে দেওয়া হবে প্রথম ব্যানার্জি স্মৃতি পুরস্কার। বর্ষসেরা কোচ হিসেবে সজিত সিনহা স্মৃতি পুরস্কার পাবেন ড. কল্যাণ চৌধুরি ও স্বপ্নান দাস। রাজ্য মিটার সেরা অ্যাথলেটিক হিসেবে সত্যরঞ্জন রায় স্মৃতি পুরস্কার পাবেন লিলি দাস। লাইফটাইম অ্যাচিভমেন্ট অ্যাওয়ার্ড দেওয়া হবে ৪ জনকে। এরা হলেন সুনীল চ্যাটার্জি, তপু দাস, অলকা হাজরা ও মল্লিকা দাস। ১১ ডিসেম্বর, রবিবার দুপুর ১২টায় মৌলভি যুব কেন্দ্রে তাঁদের হাতে পুরস্কার তুলে দেওয়া হবে। সেদিনই অ্যাথলেটিক কোচেস অ্যাসোসিয়েশন অফ বেঙ্গলের বার্ষিক আলোচনাচক্র।

নোটিস

সকলকে অবগত করা হচ্ছে যে পশ্চিমবঙ্গ সরকার-এর এনভায়রনমেন্ট ইমপ্যাক্ট অ্যাসেসমেন্ট অথরিটি (পরিবেশ দপ্তর), চিঠি সংখ্যা 2237/EN/T-II-1/126/2008 (Pt-1) তারিখ 04.10.2016 দ্বারা কলকাতা ওয়েস্ট ইন্টারন্যাশনাল সিটি প্রাইভেট লিমিটেড-এর মৌজা কোনো, বালটিকুরি, বাঁকড়া, পাকুরিয়া, তেঁতুলকুলি, খালিয়া আর সলপ-এ প্রস্তাবিত টাউনশিপ প্রজেক্ট-এর ফেজ-2B-র জন্যে পরিবেশ সম্পর্কিত ছাড়পত্র প্রদান করেছেন। ছাড়পত্রের প্রতিলিপি পশ্চিমবঙ্গ দূষণ নিয়ন্ত্রণ পর্ষদে পাওয়া যাবে।

কলকাতা ওয়েস্ট ইন্টারন্যাশনাল সিটি প্রাইভেট লিমিটেড বিচিত্রা, কলকাতা ওয়েস্ট ইন্টারন্যাশনাল সিটি, সলপ জংশান, হাওড়া-আমতা রোড এবং বোম্বে রোড ক্রশিং, এনএইচ-৬ হাওড়া - 711 403.

Mayurakshi/038/16

বর্ষসেরার দৌড়ে মেসি

আজকালের প্রতিবেদন: মেসি, রোনাল্ডো, গ্রিজমানের ত্রিমুখী লড়াই। ফিফার বর্ষসেরা ফুটবলারের পুরস্কারের দৌড়ে ২৩ জনের প্রাথমিক তালিকা থেকে বাদ পড়লেন নেইমার, বেল, সুয়ারেজ, ইব্রাহিমোভিচের মতো তারকারা। ব্যালন ডি'ওরের

পাশাপাশি এবার থেকেই বর্ষসেরাদের পুরস্কৃত করবে ফিফা। এদিকে, কোচদের চূড়ান্ত তালিকায় জিদানের সঙ্গে মনোনীত রুদী ও রানিয়ারি ও ফার্নান্দো স্যাস্টোস। গত মরশুমে প্রিমিয়ার লিগে লিটারের সাফল্যের জন্যই রানিয়ারি ফিফার বর্ষসেরা

কোচের পুরস্কারের দৌড়ে একইরকম ভাবে পূর্তগালকে ইউরো চ্যাম্পিয়ন করা স্যাস্টোস এবং চ্যাম্পিয়ন্স লিগের সাফল্যের জন্য জিদান। ২০১৬ সালে বিশ্ব ফুটবলের মধ্যে দলকে সাফল্য এনে দেওয়ার বিচারে প্রাথমিক তালিকা থেকে কাটছাট করে



মন খারাপ করা ছবি। কাপেকোয়েলের নিহত ফুটবলার, কোচ, স্টাফদের দেহ বন্দী হবে এই কফিনগুলোতেই।

শোকস্তব্ধ গ্যাব্রিয়েল

আজকালের প্রতিবেদন: ইংলিশ লিগ কাপের নকআউট পর্বের ম্যাচে সাউদামটনের কাছে অপ্রত্যাশিত পরাজয়ের ধাক্কা কাটিয়ে উঠতে পেরেছে কি না আর্সেনাল, তা বলা যাচ্ছে না। তবে আর্সেন ওয়েস্টারের দলের নির্ভরযোগ্য ব্রাজিলীয় ডিফেন্ডার গ্যাব্রিয়েল পাউলিস্তা অনেক বেশি শোকস্তব্ধ গত সোমবারের বিমান দুর্ঘটনায়। তাঁর দেশেরই ক্লাব দল কাপেকোয়েলের ২৬ জন ফুটবলারের আকস্মিক মৃত্যুর শোক যেন কাটিয়েই উঠতে পারছেন না গ্যাব্রিয়েল। বুধবারের ম্যাচের আগে তাঁর হাতে দেখা গিয়েছিল নিহতদের স্মৃতির প্রতি শ্রদ্ধা জানিয়ে লেখা একটি বানার। আর ম্যাচ শেষে আর্সেনালের সরকারি ওয়েবসাইটের সাংবাদিকের সামনে এসে ফুপিয়ে কেঁদেই ফেলেন গ্যাব্রিয়েল। কাপেকোয়েলের যে সব ফুটবলার মারা গেছেন এই ভয়াল দুর্ঘটনায়, তাঁদের অনেকের সঙ্গেই পরিচয় ছিল 'গানার্স' ডিফেন্ডারের। তবে ব্রাজিলীয় ক্লাব দল ভিটোরিয়ায় থাকাকালীন কোচ হিসেবে যাকে পেয়েছিলেন সেই কাইয়ে জুনিয়রের মারা যাওয়ার খবরটা আরও বেশি করে আঘাত দিয়েছে গ্যাব্রিয়েলকে।

পেলের প্রার্থনা



আজকালের প্রতিবেদন: গোটা ব্রাজিল যেমন শোকে মুগ্ধে পড়েছে, তিনিও তার ব্যক্তিগত নন। বিমান দুর্ঘটনায় কাপেকোয়েলের ফুটবলার, কোচ, সাপোর্ট স্টাফদের মর্মান্তিক মৃত্যুতে তিনিও শোকস্তব্ধ। ফুটবল সন্ন্যাসি পেল বলেছেন

'ব্রাজিলিয়ানদের কাছে অত্যন্ত কঠিন সময়। আমাদের, গোটা ব্রাজিলকে শোকাহত করেছে। প্রার্থনা করি, নিহতদের পরিবার যেন এই পরিস্থিতি থেকে বেরিয়ে আসার শক্তি পায়। এই পৃথিবীতে অনেক দুর্ঘটনাই ঘটে। কিন্তু এটা বেশি দুঃখের কারণ, ওরা আমাদের ভাই। তবে কঠিন সময়ও ক্ষতিগ্রস্ত পরিবারগুলোর পাশে দাঁড়াতে হবে।'

Hel per

Sunvi Group

Medical Fitness Certificate

Project :- Jayville Howrah Region :- Eastern

Certified that I, Dr. Aminul Islam Sardar have examined Mr. / Ms. SK Sarferaj
Age 19 years on (date) 03.03.2020 who has signed below in my presence.

General & Physical examination of Mr./Ms. _____ did not reveal any abnormality. He / she does not suffer from any acute / chronic skin or contagious disease like tetanus, typhoid, cholera or other infectious disease. His / her eye site is normal with / without glasses.

In my opinion, Mr./ Ms. SK Sarferaj is physically and mentally fit for working at heights or elsewhere at a construction site.

Details of examination are given below:-

Parameter	Remarks
Height	5'5"
*Chest	
Weight	59kg.
**Vision, glass No. if applicable	6/6
Hearing ability	
Pulse	60
Blood pressure	110/65

Parameter	Yes	No
Epilepsy		✓
Frequent headache		✓
Height phobia		✓
Limping gait		✓
Physical deformity		✓
Flat foot		✓
Mental depression		✓

Allergies -

Medical history of past three years: - Admitted to hospital - Yes / No, Surgeries - Yes / No

Any other health related information:

CAH JAYVILLE

Signature / thumb impression of
Workman

DR. AMINUL ISLAM SARDAR
M.B.B.S / C.M.
Reg. No. 52781
Signature & rubber stamp of
Medical Practitioner with Reg No.

*In case of Batching plant operators & cement loading/unloading labours, attach Lung function test report.

**In case of Drivers/Operators, crane signalers attach separate vision test record by an ophthalmologist

***In case of Cooks they shall be vaccinated for typhoid every three years

cleaner

BCS

Medical Fitness Certificate

Project: Joyville Houera

Region: Eastern

Certified that I, Dr. Aminul Islam Sardar have examined Mr./Mrs. Sariful Islam Age 28 years on (date) 04.03-2020 who has signed below in my presence.

General & Physical examination of Mr./Ms. _____ did not reveal any abnormality. He / she does not suffer from any acute / chronic skin or contagious disease like Malaria, typhoid, cholera or other infectious disease. His / her eye sight is normal with / without glasses.

In my opinion, Mr./Ms. Sariful Islam is physically and mentally fit for working at heights or elsewhere at a construction site.
Details of examination are given below:-

Parameter	Remarks
Height	5'6"
Weight	57 kg
*Vision, glass No. if applicable	6/6
Hearing ability	
Heart	60
Blood pressure	126/62

Parameter	Yes	No
Epilepsy		✓
Frequent headache		✓
Heigh. problem		✓
Limping gait		✓
Physical deformity		✓
Flat foot		✓
Mental depression		✓

*Surgeries:-

Medical history of past three years:- Admitted to hospital - Yes / No, Surgeries - Yes / No

Any other health related information:

স্বাক্ষর

Signature / Thumb impression of
Physician

In case of sustaining plant diseases & general loading/unloading labours, attach Lung function test report

*In case of Diabetes Mellitus, attach regulars of each sugar as well as last record by an endocrinologist

*In case of Cholera they shall be vaccinated for typhoid every three years

DR. AMINUL ISLAM SARDAR
M.B.B.S (Cal)
Regn. No. 52761

Signature & rubber stamp
Medical Practitioner with Reg. No.

Installeer

AL HIES SPORTS

Medical Fitness Certificate

Project :- Joyville - Hawrah Region :- Essex

Certified that I, Dr. Aminul Islam Sardar have examined Mr. / Ms. Tapan Kumar NASKAR Age 50 years on (date) 04-07-2024 who has signed below in my presence.

General & Physical examination of Mr./Ms. _____ did not reveal any abnormality. He / she does not suffer from any acute / chronic skin or contagious disease like tetanus, typhoid, cholera or other infectious disease. His / her eye site is normal with / without glasses.

In my opinion, Mr. / Ms. Tapan Kumar NASKAR is physically and mentally fit for working at heights or elsewhere at a construction site.

Details of examination are given below:-

Parameter	Remarks
Height	5'8"
*Chest	
Weight	65kg
**Vision, glass No. if applicable	20/25
Hearing ability	
Pulse	61
Blood pressure	119/73

Parameter	Yes	No
Epilepsy		✓
Frequent headache		✓
Height phobia		✓
Limping gait		✓
Physical deformity		✓
Flat foot		✓
Mental depression		✓

Allergies -

Medical history of past three years: - Admitted to hospital - Yes / No, Surgeries - Yes / No

Any other health related information:

J. Naskar

Signature / thumb impression of
Workman

DR. AMINUL ISLAM SARDAR
M.B.B.S. (Cal)
Regn. No. 52761

Signature & rubber stamp of
Medical Practitioner with Reg No.

*In case of Batching plant operators & cement loading/unloading labours, attach Lung function test report

**In case of Drivers/Operators, crane signalers attach separate vision test record by an ophthalmologist

***In case of Cooks they shall be vaccinated for typhoid every three years

STATE LEVEL ENVIRONMENT IMPACT ASSESSMENT AUTHORITY

Poura Bhavan, Block 'FD'-415A, 4th Floor, Sector III,

Salt Lake, Kolkata – 700 106

Telefax No. 033 2337 0268

Website : www.environmentwb.gov.in

No. 2237 /EN/ T-II-1/126/2008(Pt-1)

Date : 04 / 10 /2016

To

M/s. Kolkata West International City Pvt. Ltd.

“Vichitra”, Kolkata West International City, Salap Junction,

Howrah Amta Road and Bombay Road Crossing, NH6

Howrah – 711 403

SUB. : Environmental Clearance for the Phase 2B of the proposed Township Project by M/s. Kolkata West International City Pvt. Ltd. at Mouza – Kona, Balitikuri, Bankra, Pakuria, Tentulkuli, Khalia & Salap, PO & PS – Domjur, Dist – Howrah, West Bengal.

Sir,

This has a reference to the application for environmental clearance for the Phase 2B of the proposed Township Project by M/s. Kolkata West International City Pvt. Ltd. at Mouza – Kona, Balitikuri, Bankra, Pakuria, Tentulkuli, Khalia & Salap, PO & PS – Domjur, Dist – Howrah, West Bengal.

The proposal has been examined and processed in accordance with the EIA Notification, 2006.

It is noted that the salient features of the project (Phase 2B) for which Environmental clearance has been considered are given below:

Land Area	30.325 acres (122719 sqm.)
Latitude & Longitude	22°37'13.64"N & 88°17'25.91"E
Expected Population	18820 persons
Building profile	5 nos. of G+19, 7 nos. G+20 & 9 no G+21 storied
Total Water requirement	2940 KLD
Fresh water requirement	1763 KLD (source-KMDA supply)
Wastewater generated	2010 KLD (to be treated in Phase 2B STP)
Treated waste water recycled	1178 KLD (to be used in toilet flushing, landscaping & car washing)
Treated waste water discharge	833 KLD (to be discharged to Howrah drainage canal)
Solid waste disposal	10.5 TPD (to be disposed off through onsite compost plant & HMC)
Total Built-up Area	327439.95 sqm.
Ground Coverage	5.52 acres (22343.83 sqm.), (18.02% of land area)
Roads & Paved areas	7.54 acres (30530 sq.m) (24.88% of land area)
Exclusive tree plantation area	6.267 acres (25362 sq.m) (20.67% of land area)

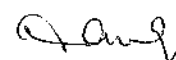

Other Green area	9.96 acres (40301 sq.m) (35.22% of land area)
Waterbody	0.367 acres (1484 sq.m) (1.21% of land area)
No. of plantation proposed	1776 nos.
No. of Car Parking spaces proposed	3361 nos.(covered-1000 nos, open-2361 nos.)
Power requirement	13 MVA (at least 1% of total power requirement shall be met from solar power)
Use of solar power	At least 100 KW of solar power to be generated and utilized in addition to stand alone solar street lights inside Phase 2B
Backup Power	DG Sets (1x1010KVA, 2x750 KVA)

State Level Environment Impact Assessment Authority (SEIAA), examined the proposal and also perused recommendations of the State Level Expert Appraisal Committee (SEAC). After due consideration of the project proposal, and the recommendations of the State Level Expert Appraisal Committee (SEAC), the State Level Environment Impact Assessment Authority accords Environmental Clearance to the project as per provisions of the EIA notification no. S.O. 1533 (E) dt. 14th September, 2006 of Ministry of Environment, Forests & Climate Change, GOI, subject to strict compliance of terms and conditions as mentioned below :-

Part A – SPECIFIC CONDITIONS

I. Construction Phase

Facility of labourers during construction: -

- Provision of drinking water, wastewater disposal and solid waste management should be ensured for labour camps. Water usage during construction should be optimized to avoid any wastage.
- Proper sanitation facilities should be provided for construction workers to ensure environmental sanitation. Sewage generated from the areas occupied by the construction labourers have to be directed into the existing sewage drain of the area. In case of non availability of the sewer system, an onsite treatment system has to be provided.
- The scaffolds, stairs and platforms for construction works and the workers must be secured as far as possible to prevent any accident.
- Health and safety of the workers should be ensured during construction. Personnel protective equipment like shoes, helmets, earmuffs, earplugs etc. should be provided to the workers. For vibration control damped tools must be used and the number of hours that a worker uses them must be limited. The Management must ensure that the workers put them while doing work that needs such protection, if any.
- Rest and convenience shelter for workers with crèche facility, if required, particularly for women, must be provided with proper toilet facilities.

Steps to avoid disturbance during construction:-

- All the topsoil excavated during construction activities should be under cover/stored by retaining walls for use in horticulture / landscape development within the project site. Adequate erosion and sediment control measures to be adopted before ensuing construction activities.
- Prior permission should be obtained from the competent authority for demolition of the existing structure, if any. Waste recycling plans should be developed for prior to beginning of demolition and construction activity. The plans should identify wastes to be generated and designate handling, recycling and disposal method to be followed.

Paul

- iii. Disposal of muck including excavated material during construction phase should not create any adverse effects on the neighbouring communities and disposed off taking the necessary precautions for general safety and health aspects.
- iv. Diesel generator sets during construction phase should have acoustic enclosures and should conform to E(P) Rules prescribed for air and noise emission standards.
- v. Vehicles / equipment deployed during construction phase should be in good condition and should conform to applicable air and noise emission standards and should be operated only during non-peak hours.
- vi. Ambient noise levels should conform to residential standards both during day and night. Fortnightly monitoring of ambient air quality (SPM, SO₂ and NO_x) and equivalent noise levels should be ensured during construction phase.
- vii. Construction spoils including bituminous material and other hazardous materials including oil from construction equipments must not be allowed to contaminate watercourses and the dumpsites for such material must be secured so that they should not leach into the ground water. If necessary, oil trap should be installed where there is deployment of heavy machineries.
- viii. Regular supervision of the above and other measures should be in place all through the construction phase so as to avoid disturbance to the surroundings. Discomfort in the neighbourhood due to the proposed project activity should be minimized as far as practicable.
- ix. Loading and unloading operations should not be carried out in open areas and should be preferably done during day time, if there is any major settlement in the surrounding areas. The construction activities including Piling work, Operation of Ready Mix Plant and Vibrator etc. should not be carried out during the night time (10 P.M. to 6 A.M.). Only essential operations, if any, may be carried out for a limited period during nighttime.
- x. The proponent must ensure that no driven piles shall be proposed for this project, if there is any major settlement in the surrounding areas.
- xi. 15m-screen and adequate sprinkler arrangement shall be provided. Care should be taken to keep all material storages adequately covered and contained so that they are not exposed to winds.
- xii. Use of Ready-Mix concrete is recommended for this project.
- xiii. Adequate measures to be adopted to avoid wastage of water for curing of concrete structures.
- xiv. Adequate mitigative measures should be adopted to control dust emissions, noise and vibrations from construction activities. Vehicles and construction machineries should be properly maintained. Vehicles should conform to Pollution under control (PUC) norms.
- xv. Locally available materials with less transportation cost should be used preferably.
- xvi. Promotion of use of cleaner fuel and fuel quality improvement should be done. Excessive energy consumption and fuel usage should be avoided.
- xvii. Accumulation / stagnation of water should be avoided to ensure vector control.

Selection of materials for better energy efficiency:-

- i. Use of energy efficient construction materials should be ensured to achieve the desired thermal comfort.
- ii. Design layout should ensure adequate solar access and ventilation. Proper planning and window design for daylight integration should be considered.
- iii. Fly Ash is to be used for construction as per Notification No. S.O. 763(E) dated 14.09.1999 amended vide Notification No. S.O. 979(E) dated 27.8.2003 and S.O. 2804(E) dated 03.11.2009 of the Ministry of Environment & Forests, Govt. of India.
- iv. Construction should conform to the requirements of local seismic regulations. The project proponent should obtain permission for the plans and designs including structural design, standard and specifications from concerned authority.

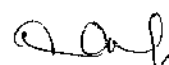

- v. Construction technologies that require less material and possess high strength should be adopted. Materials with low embodied energy and high strength should be used preferably.
- vi. The building will be constructed and provisioned to use natural sunlight to the maximum during the day time, during use.
- vii. Use of alternate building materials and alternate construction techniques should be considered apart from the conventional materials and methods. Use of hollow unit masonry should be considered.
- viii. Use of energy efficient lighting systems e.g. High Pressure Sodium Vapour (HPSV) Lamps, LED etc. should be promoted. Solar energy should be used for outdoor lighting. Adequate no. of solar lights should be installed for external lighting as per norms. All common area lighting will be LED system.
- ix. Solar water heating arrangement will be done for water heating .
- x. Passive solar cooling to be incorporated in building design. Buildings should be oriented for ensuring natural ventilation and daylighting.
- xi. Proper insulation of roof should be provided to achieve desired thermal comfort. Use of light coloured, reflective roofs having an SRI (solar reflectance index) of 50% or more should be incorporated.
- xii. Use of high albedo or reflective pavements to keep parking lots, pavements and inside roads cool should be incorporated.
- xiii. Guidelines to the occupants should include usage efficiency measures such as energy efficient lighting and water efficient system.
- xiv. Reduce hard paving-onsite (open area surrounding building premises) and/or provide shade on hard paved surfaces to minimize heat island effect and imperviousness of the site.
- xv. Adequate open space, greenery and water bodies to be provided as per rules.
- xvi. Any proposed building with air-conditioning facility should follow the norms proposed in the ECBC regulations framed by the Bureau of Energy Efficiency. Chillers should be CFC & HCFC free.
- xvii. Restrict the use of glazed surface as per National Building Code 2005.

Water Body Conservation:-

- i. Water body if any should not be lined and their embankments should not be cemented. The water body is to be kept in natural conditions without disturbing the ecological habitat.

Plantation Proposal:-

- i. The unit should strictly abide by The West Bengal Trees (Protection and Conservation in Non-Forest Areas) Rules, 2007. The proponent should undertake plantation of trees over at least 20% of the total area.
- ii. No tree can be felled without prior permission from the Tree Cutting Authority constituted as per the West Bengal Trees (Protection and Conservation in Non-Forest Areas) Act, 2006 and subsequent rules.
- iii. The proponent should plant at least 1776 trees. Indicative list of species is given at Annexure – I. The landscape planning should include plantation of native species. The species with heavy foliage, broad leaves and wide canopy cover are desirable. Water intensive and/or invasive species should not be used for landscaping.
- iv. Provision for Roof Top Gardening is mandatory.

Water supply:-

- i. Water requirement during construction phase shall be met from KMDA supply. Ground water should not be abstracted without prior permission of the competent authority as per the West Bengal Ground Water Resources (Management, Control and Regulation) Act, 2005.



Sewage Treatment Plant:-

- i. As per the proposal submitted by the proponent waste water shall be treated in septic tank to soak pit. Construction waste water to be collected in sedimentation trap with adequate retention time and to be reused.

Storm water Management & Mitigation of Heat Island Effect:-

- i. Imperviousness of the site shall not exceed the NBC (National Building Code 2005) standards for imperviousness factor applicable to different types of area.
- ii. Total paved area of site under parking, roads, paths or any other use should not exceed 25% of the site area.
- iii. Minimum 50% of paved area on site should have pervious paving or shaded under vegetation or topped with finish having solar reflectance of 0.5 or higher.
- iv. Adequate storm water drainage network to be designed for the project without disturbing the surrounding settlements. Storm water management plan should be implemented so as to prevent sudden discharge of excessive volumes of storm water to the receiving waters thus reducing the shock load on the drainage system and impact on receiving water body.
- v. Disruption to the natural hydrology of the site should be minimised by reducing impervious cover, increasing on site infiltration and managing storm water run off.
- vi. Heat island effect should be minimized by use of shading or reflective surfaces, mainly the surfaces that contribute to the heat island effect i.e. streets, sidewalks, parking lots and buildings. White roofs should be provided in the buildings.

Rain Water Harvesting Scheme:-

- i. The proponent must follow the Rainwater Harvesting Guidelines of the State Expert Appraisal Committee (SEAC) available in the website (<http://www.wbpcb.gov.in>).
- ii. The proponent must collect rainwater from roof-top catchments and reuse for various purposes after necessary cleaning. Adequate retention time and storage provisions should be provided for harvesting rainwater.
- iii. Adequate firefighting storage should be provided as per norms.

Municipal Solid Waste Management :-

- i. Adequate provision shall be made for storage and segregation of solid waste and adequate means of access shall be provided.

Transport Management: -

- i. Both internal and external traffic planning and management should be adequate to ensure uninterrupted traffic movement in the area during construction as well as operation phase.
- ii. The design of service road and the entry and exit from the project area should conform to the norms & standards of competent authority for traffic management. Bell mouth type arrangement should be made at the entry & exit. Proper traffic management plan should be adopted in consultation with Traffic authorities.
- iii. Clarified Wastewater will be used for sprinkling water on the unpaved internal roads on a regular basis.

Others:-

- i. All mandatory approvals and permission as required from Director of Explosives, Fire Department etc. should be obtained.
- ii. Provision of Effective Controls and Building Management Systems such as Automatic Fire Alarm and Fire Detection and Suppression System etc. must be ensured.
- iii. Efficient management of indoor air quality must be ensured for health and safety of the users.



- iv. Adequate measures to be adopted for water conservation during construction and operation stage. Use of efficient irrigation equipment, evaporative cooling unit in air-conditioning system etc should be considered.
- v. Rest room facilities should be provided for service population.
- vi. Adequate access to fire tenders should be provided.

II. Operation Phase

Water supply :-

- i. Water requirement during construction phase shall be met from KMDA supply. Ground water should not be abstracted without prior permission of the competent authority as per the West Bengal Ground Water Resources (Management, Control and Regulation) Act, 2005.
- ii. Use of water meter conforming to ISO standards should be installed at the inlet point of water uptake to monitor the daily water consumption and records to be maintained. Use of water efficient devices / fixtures and appliances should be promoted.
- iii. **Dual plumbing system to be installed for maximum use of treated wastewater.**
- iv. The proponent must practice rainwater harvesting on regular basis.

Sewage Treatment Plant:-

- i. Dedicated STP to be provided for Phase 2B. Entire waste water shall be treated in STP. Treated waste water shall be partly reused for toilet flushing, landscaping, internal road and pavement cleaning etc. and rest to be discharged.
- ii. Water meter to be installed at STP inlet & discharge outlet point of treated water and regular records to be maintained.
- iii. Provision for backup power for operation of STP during power failure should be made.

Emission from Diesel Generator Set: -

- i. Noise barriers will be provided at appropriate locations so as to ensure that the noise levels do not exceed the prescribed standards. Diesel generator sets should be provided with integral acoustic enclosure at the manufacturing stage itself as per CPCB norms.
- ii. The stack height and emissions from D.G. sets should conform to the norms of Central Pollution Control Board. The certification of space design for DG sets should be done by competent authority.

Ensure Energy Efficiency:-

- i. Use of energy efficient construction materials to achieve the desired thermal comfort should be incorporated. The desired level of R and U factors must be achieved. U factor for the top roof should not exceed 0.4 Watt/sq.m/degree centigrade with appropriate modifications of specifications and building technologies. The provisions of National Building Code 2005 should be strictly followed.
- ii. Use of energy efficient electrical systems should be promoted. High efficiency lamps with electronic ballasts should be used.
- iii. Energy efficient Motors and properly rated Transformers should be installed. Manufacturer's certificate to this effect shall be obtained and kept on record. Back up power supply should be based on cleaner fuel.
- iv. The power cabling shall be adequately sized as to maintain the distribution losses not to exceed 1% of the total power usage. Record of transmission losses shall be maintained. The proponent shall install permanent electrical metering to record demand (kVA), energy (kWh) and total power factor.
- v. At least 100 KW of solar power to be generated and utilized in addition to stand alone solar street lights inside Phase 2B.
- vi. The project proponent should use solar energy at least for street lighting.

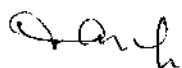

Transport Management:-

- i. Use of public mode of transportation should be promoted. Use of the least polluting type of transportation should be promoted. Adequate parking space should be provided as per norms.
- ii. Pathways should be covered or shadowed by tree canopy as far as practicable. Transport system should be such that traffic will be calm in neighbourhoods. Traffic within the project site should be restricted by regulation. Adequate vertical and horizontal clearances of overhead electric power and telecommunication lines should be provided.
- iii. Dedicated cycle tracks should be included inside the Phase 2B.

Solid Waste Management:-

- i. The proponent should abide by the Municipal Solid Wastes (Management and Handling) Rules, 2000. The proponent must develop the Solid Waste Management and Disposal Scheme ensuring storage and segregation of biodegradable and non-biodegradable wastes. The solid waste is to be disposed off in consultation with concerned municipality.
- ii. The proponent shall install onsite compost plant for treatment of biodegradable part of Municipal Solid Waste. Sufficient space for installation of onsite compost plant should be provided and operation of the compost plant considering full occupancy of the apartments i.e. the capacity of garbage disposal unit should be selected accordingly.
- iii. The handling agency should also take care of the recyclable wastes like plastic, paper board, glass etc. and also inert materials in case of respective municipal authorities want to avoid any kind of waste from the housing complex.
- iv. The proponent should have sufficient area for horticulture where the compost generated can be used as fertilizer and soil supplement and also have arrangement for sale of excess quantity of compost.
- v. Provision for treatment of leachate generated and odor control in onsite compost plant should be made.
- vi. Non-recyclable inorganics and rejects will be disposed off through municipality as proposed.
- vii. The proponent should provide different coloured bins for different categories of waste and ensure complete segregation of biodegradable and non-biodegradable wastes. The solid waste from different collection and storage bins should be finally collected at transfer stations. Further segregation will be done at transfer stations to collect recyclables such as plastic, polythene, glass, metals, textiles, rubbers, leathers, paper etc. Separate compartments shall be provided for each type of recyclables.
- viii. The proponent should abide by the Hazardous Wastes (Management, Handling and Transboundary Movement) Rules, 2008. Collection and storage of hazardous wastes during Pre-construction and Post-construction activity should be planned properly. The expected hazardous wastes should be disposed off separately as per the Hazardous Wastes (Management, Handling and Transboundary Movement) Rules, 2008.
- ix. Spent oil from DG Sets should be stored in HDPE drums in isolated covered facility and disposed off as per the Hazardous Wastes (Management, Handling and Transboundary Movement) Rules, 2008. Spent oil from DG Sets should be disposed off through registered recyclers only.

Others :-

- i. The implementation of Environmental Management Plan should be carried out, as proposed. Regular monitoring should be carried out during construction and operation phases.
- ii. The project proponent should provide guidelines to the users to ensure conservation of energy and water. In-house environmental awareness campaigns should be carried out at regular intervals to ensure environmental protection.



- iii. Fire fighting systems should be designed in compliance with the WBFS and NBC norms. Preventive measures should be adopted for Risk & Disaster Management as per the provisions of the National Building Code 2005.
- iv. Public utility services such as common public toilets to be provided.
- v. The Corporate Social Responsibility Plan with specific financial commitment should be implemented for the proposed project. At least 2% of the total project cost should be utilized for Corporate Social Responsibility programmes.
- vi. The proponent should abide by the Direction issued by the Department of Environment, Government of West Bengal, vide No. EN/3170/T-IV-7/001/2009 dated 10.12.2009.
- vii. Environmental Management Information System shall be maintained properly.
- viii. The proponent should restrict the use of glazed surface as per National Building Code, 2005.
- ix. All the recommendations made in the EIA/EMP report should be complied with.
- x. Fraction of covered area that would be illuminated by natural lighting of the proposed buildings to be reported in the first compliance report.
- xi. Fire escape, evacuation plan and means thereof, the refuge areas and floor levels to be reported in the first compliance report.
- xii. All the conditions stipulated for individual phases in the EC for the whole township vide no. 572 /EN/ T-II-I/126/2008 dated 09 / 03 /2016 should be complied with.

Part-B GENERAL CONDITIONS

- i. The environmental clearance accorded shall be valid for a period of 7 years for the proposed project.
- ii. Prior Consent-to-Establish (NOC) for the proposed project must be obtained from WBPCB by the proponent. All other statutory clearances should be obtained by project proponent from the competent authorities.
- iii. The proponent should maintain a display board at the site, providing detailed information on the salient features of the proposed project.
- iv. The environmental safeguards contained in the EIA/EMP report should be implemented in letter and spirit.
- v. All the conditions, liabilities and legal provisions contained in the EC shall be equally applicable to the successor management of the project in the event of the project proponent transferring the ownership, maintenance of management of the project to any other entity.
- vi. Provision should be made for the supply of kerosene or cooking gas to the labourers during construction phase. All the labourers to be engaged for construction works should be screened for health and adequately treated before issue of work permits.
- vii. The project proponent should make financial provision in the total budget of the project for implementation of the suggested safeguard measures.
- viii. Six monthly monitoring reports should be submitted to the West Bengal Pollution Control Board, who would be monitoring the implementation of environmental safeguards and should be given full cooperation, facilities and documents / data by the project proponents during their inspection. A complete set of all the documents should also be forwarded to the State Level Environment Impact Assessment Authority, West Bengal.
- ix. In case of any violation of the conditions laid down in this Environmental Clearance, Section 16 of The Environment (Protection) Act, 1986, will be applicable. In case of any change(s) in the scope of the project, the project would require a fresh appraisal by the SEIAA, West Bengal.
- x. The State Level Environment Impact Assessment Authority, West Bengal reserves the right to add additional safeguard measures subsequently, if found necessary, and to take action including revoking of the environment clearance under the provisions of the Environmental (Protection) Act,

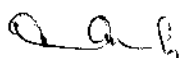

1986, to ensure effective implementation of the suggested safeguard measures in a time-bound and satisfactory manner.

- xi. The Project Proponent should inform the public that the proposed project has been accorded environmental clearance by the SEIAA, West Bengal and copies of the clearance letter are available with the State Pollution Control Board / Committee and may also be seen at website of the SEIAA, West Bengal (<http://environmentwb.gov.in>). This should be advertised within seven days from the date of issue of the clearance letter, at least in two local newspapers that are widely circulated in the region of which one shall be in the vernacular language of the locality concerned.
- xii. All other statutory clearances such as the approvals for storage of diesel from Chief Controller of Explosives, Civil Aviation Department (if required) etc. shall be obtained by project proponents from the competent authorities.
- xiii. Provision for incorporation of appropriate conditions in the Sale Agreement / Deed, for ensuring sustained Operation and Maintenance (O&M) of the common facilities (STP, Rainwater harvesting system, Solid waste management system, Solar street lights etc.) even after transfer of ownership of the project, should be made in explicit and transparent manner.
- xiv. The above stipulations would be enforced along with those under the Water (Prevention and Control of Pollution) Act, 1974, the Air (Prevention and Control of Pollution) Act, 1981, the Environment (Protection) Act, 1986, the Hazardous Wastes (Management, Handling and Transboundary Movement) Rules, 2008, the Public Liability Insurance Act, 1991, the Environment Impact Assessment Notification 2006 and their amendments.
- xv. The contact details of the proponent and the name of the consultant are given below –

Name of the Contact person with Designation	Chinmoy Mukherjee, Vice-President (Construction)
Address	Vichitra, Kolkata West International City, Salap, NH-6, Howrah-711403
Email	contact@kwic.co.in
Telephone Number, Fax Number	Ph no. +91-3330026000, Fax no-3303256508
Name of the Consultant	M/s. Ghosh Bose & Associates Pvt. Ltd.

(Sandipan Mukherjee, IFS)
Chief Environment Officer &
Member Secretary, SEIAA

No. 2237 /EN/ T-II-I/126/2008/(Pt-I)/1(3)

Date : 04 / 10 /2016

Copy forwarded to :-

1. Secretary, SEAC & M.S. WBPCB
2. Officer-in-Charge, Regional Office (Eastern Zone), Ministry of Environment & Forests, Government of India, A-3, Chandrashekharpur, Bhubaneswar – 751 023, Orissa.
3. Guard file / Record file.

Sd/-
Chief Environment Officer &
Member Secretary, SEIAA

LIST OF TREES PROPOSED FOR PLANTATION

Sl. No.	BOTANICAL NAME	COMMON NAME	QUANTITY
1.	<i>Delonix regia</i>	Gulmohor	200
2.	<i>Mimusops elengi</i>	Bakul	250
3.	<i>Peltophorum pterocarpum</i>	Radhachura	100
4.	<i>Alstonia scholaris</i>	Chhatim	100
5.	<i>Bauhinia variegata</i>	Raktakanchan	250
6.	<i>Cassia fistula</i>	Amaltas	100
7.	<i>Michelia champaca</i>	Golden Champa	100
8.	<i>Spathodea campanulata</i>	Tulip Tree	100
9.	<i>Tabebuia rosea</i>	Rosy Trumpet Tree	100
10.	<i>Jacaranda mimosifolia</i>	Nil Gulmohor	200
11.	<i>Thespesia populnea</i>	Poros	76
12.	<i>Polyalthia longifolia</i>	Debdaru	100
13.	<i>Lagerstroemia speciosa</i>	Jarul	100
		Total	1776

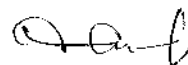

WEST BENGAL POLLUTION CONTROL BOARD

Paribesh Bhawan
10A, Block-LA, Sector-III
Bidhannagar, Kolkata-700 098

Memo No. 64-SEE-Camac/WBPCB-KWIC-Howrah-125/2006/PART-I Dated 14.02.2017



From :
Member Secretary,
West Bengal Pollution Control Board

To: M/s. Kolkata West International City Pvt. Ltd.
"Vichitra", Kolkata West International City,
Salap Jn. Howrah-Amta Road, & Bombay Road,
NH-6, Howrah-711403.

Sub: Consent to Establish (NOC) from Environmental Point of View

Ref: i) Your letter No. KWIC/SP/PLNG/I/2016-17/074 Dated 18.01.2017
ii) EC issued by SEIAA, WB vide no.2237/EN/T-II-1/126/2008(Pt-I)
dated 04.10.2016

Dear Sirs,

In response to the application for Consent to Establish (NOC) for proposed Unit of M/s Kolkata West International City Pvt. Ltd. - PHASE 2B expansion for manufacturing/storage/installation construction of residential complex having 5 nos. of G+19, 7 nos. of G+20 & 9 nos. G+21 storied with total built up area 327439.95 sqm. at Mouza-Kona, Baltikuri, Bankra, Pakuria,* this is to inform you that this Board hereby grants the Consent to Establish (NOC) from the environmental point of the above subject to the following conditions and special conditions annexed.

*Tentulkuli, Khalia & Salap, PO & PS-Domjur, Dist-Howrah.

1. The quality of sewage and trade effluent to be discharged from your factory shall satisfy the permissible limits as prescribed in IS : 2490 (Pt. I) of 1974, and/or its subsequent amendment and Environment (Protection) Rules 1986.
2. Suitable measures to treat your effluent shall be adopted by you in order to reduce the pollutional load so that the quality of the effluent satisfies the standards mentioned above.
3. You shall have to apply to this Board for its consent to operate and discharge of sewage and trade effluent according to the provisions of the water (Prevention & Control of Pollution) Act, 1974. No sewage or trade effluent shall be discharged by you without prior consent of this Board.
4. All emission from your factory shall conform to the standards as laid down by this Board.
5. No. emission shall be permitted without prior approval of this Board and you shall apply to this Board for its consent to operate and atmospheric emission as per provision of the Air (Prevention & Control Pollution) act, 1981.
6. No industrial plant, furnace, flues, chimneys, control equipment, etc. shall be constructed/reconstructed/erected/re-erected without prior approval of this Board.

14.02.17

7. You shall comply with
- Water (Prevention and Control of Pollution) Cess Act, 1977, if applicable.
 - Water (Prevention and Control of Pollution) Cess Act, 1978, if applicable.
 - Environment (Protection) Act, 1986
 - Environment (Protection) Rules, 1986
 - Hazardous Wastes (Management and Handling) Rules, 1989 and Amended Rules, 2000
 - Manufacture, Storage and Import of Hazardous Chemicals Rules, 1989 and Amended Rules, 2000
 - Manufacture, Use, Import and Storage and Hazardous Micro-Organisms, Genetically Engineered Organisms or Cell Rules, 1989
 - The Public Liability Insurance Act, 1991 and Amended Act, 1992
 - The Public Liability Insurance Rules, 1991 and Amended Rules 1993
 - Biomedical Wastes (Management & Handling) Rules, 1998 and Amended Rules 2000 if applicable.
 - Recycled Plastics Manufacture and Usage Rules 1999, if applicable and
 - Ozone Depleting Substances (Regulation & Control) Rules, 2000, if applicable
8. You will have to abide by any other stipulations as may be prescribed by any authority/local bodies/Government Departments etc.

SPECIAL CONDITION :

Gross capital investment of the Phase 2B project Rs.242 crores.

Please refer to annexure attached herewith.

Any violation of the aforesaid conditions shall entail cancellation of this Consent to Establish (NOC)

Yours faithfully,

Sr. Env. Engineer (EIM Cell)

Member Secretary,

West Bengal Pollution Control Board

Memo No. SEE-Camac/WBPCB-KWIC-Howrah-125/2006/Part-I dated
Copy forwarded for information to :

- Chief Inspector of Factories, Government of West Bengal, N. S. Building, Kolkata-700 001
- Director of Industries/Director of Cottage & Small Scale Industries, Government of West Bengal, N. S. Building, Kolkata-700 001
- Guard file, West Bengal Pollution Control Board.
- Environmental Engineer, I/II/Alipur R.O./Howrah R.O./Hooghly R.O./B.R.O./D.R.O./Haldia R.O./S.R.O./Asansol/ Sub-R.O./WBPC Board

Himalaya Bhawan
Delhi Road, Dankuni
Dist. Hooghly

Vill, Panpur
Kalyani Expressway
P.O. Narayanpur
Dist. 24 Pgs. (N)

Sahid Khudiram Sarani
City Centre, Durgapur-16
Dist. Burdwan

10, Camac Street
2nd Floor
Kolkata-700 017

Paribesh Bhawan
10A, LA-Block, Sector-III
Salt Lake City,
Kolkata - 700 098

Block-05 at 40
Flats Complex
Adjacent to Priyambada
Housing Estate
P.O. : Khanjanchak,
P.S. Durgachak
Haldia-721602
Dist. : Purba Medinipur

Paribahan Nagar
Matigara, Siliguri
Dist.-Darjeeling

Satya Chowdhury
Indoor Stadium
Balurchar Bandh Road

Asansol Sub-Regional Office
ADDA Commercial Market (2nd Floor)
Opposite Asansol Fire Station

Sr. Env. Engineer (EIM Cell)
Member Secretary,

West Bengal Pollution Control Board

Special Conditions issued to M/s. Kolkata West International City Pvt. Ltd. for phase-2B at Mouza-Kona, Baltikuri, Bankra, Pakaria, Tentulkhali, Khalia & Salap, P.O & P.S-Domjur, Dist-Howrah.

pg 1 of 2

A. **Emission:-** DG Sets - 1x1010 KVA & 2x750 KVA.

Stacks -

1. Each DG sets to be provided with acoustic enclosures and residential silencer with individual stacks of adequate ht. above the roof of DG building.
2. Stacks to have sampling port, platform and ladder as per the Emission Regulation Part - III of CPCB.
3. Emission standards, Fuel specification and Stack height should comply with the prescribed limits under the notification of Ministry of Environment & Forest, Govt. of India, G.S.R. 489(E) [09.07.2002] and subsequent amendments.

B. **Effluent:-** Domestic - waste water shall be treated in adequately designed STP. Treated waste water shall be partly reused and partly discharged to municipal drain. Discharge of treated waste water shall conform to E(P) Rules. Sewage Treatment Plants should be monitored on a regular basis and records should be maintained properly.

C. **Solid Waste :-** to be collected and disposed off regularly as per the Municipal Solid Wastes (Management and Handling) Rules, 2000 and Solid Waste Management Rules, 2016. The project proponent shall install on-site compost plant for treatment & disposal of bio-degradable fraction of MSW.

D. **General:-**

1. The Project Proponent shall have to obtain prior concurrence from the concerned municipality for ensuring supply of water, partial discharge of treated sewage and disposal of solid wastes.
2. D.G. Set noise level should not exceed the permissible limit. The Project Proponent should ensure that the ambient noise level is maintained within permissible limits during the construction phase.
3. The proponent should strictly comply with the standards / guidelines for control of noise from stationery Diesel generator sets. These standards and guidelines are prescribed under the notifications of Ministry of Environment & Forest, Govt. of India, G.S.R. 371(E) [17.05.2002], G.S.R. 489(E) [09.07.2002] and subsequent amendments.
4. The proponent should obtain necessary clearance for DG Sets from the Directorate of Electricity before applying for Consent-to-Operate.
5. The following activities are restricted during the night time (10 pm to 6 am), if there is any significant human settlement in the vicinity:
 - a) Piling work.
 - b) Operation of Ready Mix Plant, if installed and Vibrator.
 - c) Loading and unloading of construction materials.
6. Adequate measures are to be taken to reduce vibration during piling work.
7. Water sprinkling arrangement should be ensured at every loading and unloading point to prevent spreading of dust. Rubbish, debris, broken materials and others must be kept properly within project area at suitable place with proper water sprinkling to prevent fugitive dust spreading.
8. Provision of drinking water, wastewater disposal and solid waste management should be ensured for labour camps. Proper sanitation facilities should be provided for construction workers to ensure environmental sanitation. Health and safety of the workers should be ensured during construction.
9. The project proponent should take necessary care not to cause any inconvenience to the residents of surrounding neighbourhood. Regular supervision should be in place all through the construction phase so as to avoid disturbance to the surroundings.
10. The Project Proponent will ensure that no accumulation of any kind of water occurs within the project area to prevent breeding of various disease spreading vectors.
11. Necessary dust barrier should be provided during construction phase. Before taking up the construction work it is preferable to enclose the area with some enclosure.
12. Appropriate arrangement is to be done for rainwater harvesting within the site. The proponent must practice rainwater harvesting on regular basis.
13. Ground water should not be abstracted without prior permission of the Local body as well as the Competent Authority as per the West Bengal Ground Water Resources (Management, Control and Regulation) Act, 2005.



Sr. Environmental Engineer
W B Pollution Control Board
Dept. of Environment, CSWB

Annexure I to NOC Sl. No. **NO147004**

Special Conditions issued to **M/s. Kolkata West International City Pvt. Ltd. for phase-2B at Mouza-Kona, Baltikuri, Bankra, Pakuria, Tentulkhali, Khalia & Salap, P.O & P.S-Domjur, Dist-Howrah.**

- pg 2 of 2
14. Provision of screen wall should be made surrounding the batching plant, if installed for control of fugitive emission from such operation.
 15. Fly Ash is to be used for construction as per Notification No. S.O. 763(E) dated 14.09.1999 amended vide Notification No. S.O. 979(E) dated 27.8.2003 and S.O. 2804(E) dated 03.11.2009 of the Ministry of Environment & Forests, Govt. of India.
 16. The proponent should strictly abide by The West Bengal Trees (Protection and Conservation in Non-Forest Areas) Rules, 2007. No trees can be felled without prior permission from the Tree Cutting Authority constituted as per the West Bengal Trees (Protection and Conservation in Non-Forest Areas) Act, 2006 and subsequent rules.
 17. Proper steps are to be taken so that the flora and fauna are not affected during the construction phase.
 18. Adequate firefighting storage should be provided as per Rules.
 19. Adequate parking space should be provided within the project site as per Rules.
 20. Road design should be done with due consideration for environment and safety of users. The entry and exit points should be designed properly without disturbing the existing traffic.
 21. Use of energy efficient construction materials should be ensured. Water efficient devices / fixtures should be installed. Energy efficient systems should be installed.
 22. Adequate provision shall be made for storage of solid waste and adequate means of access shall be provided. Vats / bins should be provided inside the project area from where the wastes are to be disposed off by arrangement with the local body.
 23. The proponent shall undertake awareness programmes for the residents to promote water and energy conservation and to ensure environmental protection.
 24. No expansion of the project should be undertaken without prior permission of the State Board.
 25. The unit should not start operation without obtaining 'Consent to Operate' from this Board.
 26. The proponent should maintain a display board at the site, providing detailed information on the salient features of the proposed project.
 27. No water bodies should not be lined and their embankments should not be cemented.
 28. The proponent should abide by the Direction issued by the Department of Environment, Government of West Bengal, vide No. EN/3170/T-IV-7/001/2009 dated 10.12.2009 (**Annexure II**).
 29. The proponent should strictly abide by the conditions stipulated in the Environmental Clearance accorded by the State Environment Impact Assessment Authority (SEIAA), West Bengal, vide No. 2237EN/T-II-1/126/2008(Pt-1) dated 04.10.2016.
 30. This NOC is valid up to **31.01.2024** for Phase 2B of township comprising of 5 nos. G+19, 7 nos. G+20 & 9 no. G+21 storied over an area of **30.325 acres** and total built-up area of project shall be **327439.95 sq.m.**

19/02/17

Member Secretary
West Bengal Pollution Control Board

Sr. Environmental Engineer
WB Pollution Control Board
Dept. of Environment, GoWB



Department of Environment
Government of West Bengal
Writers' Buildings, "G" Block, (2nd. Floor),
Kolkata-700 001.

No. EN/3170/T-IV-7/001/2009

Dated: December 10th, 2009.

DIRECTION

WHEREAS, Department of Environment, Govt. of West Bengal is entrusted to look after the execution of the different environmental laws within the territorial jurisdiction of West Bengal and also responsible for maintaining pollution free environment and also responsible for restraining different environment hazardous activities which are causing serious impact on human beings, other living creatures, plant, micro-organism, property or the environment ;

AND WHEREAS, Department of Environment has already taken different steps for controlling air pollution in the atmosphere generated from the different sources i.e. industrial source, vehicular source and burning of biomass;

AND WHEREAS, Department of Environment in exercising the power conferred under section 19 of the Air (Prevention & Control of Pollution) Act, 1981, has already declared entire West Bengal as 'Air Pollution Control Area';

AND WHEREAS, West Bengal Pollution Control Board conducted a study with the help of the Asian Development Bank and it is revealed that the contribution of the construction activities is one of the source of air pollution in Kolkata and its surroundings ;

AND WHEREAS, it is further revealed that burning of old tyres in hot mix plant as a fuel during construction and repairs of road for melting coal tar contributes significant obnoxious element into the air which cause a serious problem of the human beings ;

HENCE, in view of the above and in consultation with the West Bengal Pollution Control Board and in exercise of the power conferred under Air (Prevention & Control of Pollution) Act, 1981 and Environment (Protection) Act, 1986, all the municipalities, local authorities and all other concerned Govt. Departments within the State of West Bengal, are now directed to take immediate steps to implement the following norms which need to be strictly followed by the developers, contractors or any other infrastructure developers ;

• Preventive measures need to be taken: -

- a) Wrap construction area/buildings with geotextile fabric, installing dust barriers, or other actions, as appropriate for the location,
- b) Apply water and maintain soils in a visible damp or crusted condition for temporary stabilization,
- c) Apply water prior to levelling or any other earth moving activity to keep the soil moist throughout the process;
- d) Limit vehicle speeds to 15 mph on the work site.
- e) Clean wheels and undercarriage of haul trucks prior to leaving construction site.
- f) Apply and maintain dust suppressant on haul routes.
- g) Apply a cover or screen to stockpiles and stabilize stockpiles at completion of activity by water and maintain a dust palliative to all outer surfaces of the stockpiles;
- h) Stabilize surface soils where loaders, support equipment and vehicles will operate by using water and maintain surface soils in a stabilized condition where loaders, support equipment and vehicles will operate;
- i) Stabilize adjacent disturbed soils following paving activities with immediate landscaping activity or installation of vegetative or rock cover.
- j) Maintain dust control during working hours and clean track out from paved surfaces at the end of the work shift/day. Track out must now extend 50 feet or more and must be cleaned daily, at the minimum.
- k) Stabilize sloping surfaces using soil binders until vegetation or ground cover can effectively stabilize the slope,
- l) Disposal of debris in consultation with the local authorities following proper environmental management practice.
- m) During construction work, including cutting of marbles, ambient noise level should not exceed more than 65 dB(A).

• Practices to be discarded: -

- a) Don't dispose of debris indiscriminately,
- b) Don't allow the vehicles to run at high speed within the work site.
- c) Don't cut materials without proper dust control/noise control facility.
- d) Don't keep materials without effective cover.
- e) Don't allow access in the work area except workers to limit soil disturbance and prevent access by fencing, ditches, vegetation, berms or other suitable barrier.
- f) Don't leave the soil, sand and cement stack uncovered.
- g) Don't keep materials or debris on the roads or pavements.
- h) Burning of old tyres in hot mix plant as a fuel during construction and repair of the roads for melting coal tar should be discarded ;

NOW THEREFORE, it is made clear that any developers, contractors or infrastructure developers either Govt. or Private failed to comply with the aforementioned statutory norms, Department of Environment and West Bengal Pollution Control Board will take necessary action under Air (Prevention & Control of pollution) Act, 1981 and Environment (Protection) Act, 1986 which may lead to stoppage and prohibition of the work including closure and other legal action as warranted under the law including imposition of the 'Pollution Cost'.

It is further directed that all Municipal Corporations, Municipalities and Panchayats should also be at liberty to take necessary action against the violators under the Municipal Laws and Panchayat Law.

But it is made clear that Local Authorities i.e. Municipal Corporations, Municipalities and Panchayats are responsible to implement the aforementioned guidelines meticulously for the purpose of curbing air pollution and other environmental hazards of their respective jurisdiction.

Local Police Station is also directed to render all necessary help to the Local Authorities to implement the aforementioned direction in a befitting manner.

This order will take effect from 01-01-2010 through out the State of West Bengal.

By Order,
Sd/-

(M. L. Meena)

Principal Secretary to the Govt. of West Bengal.
Department of Environment.

No. EN/3170/T-IV-7/001/2009

Dated: December 10th, 2009.

Copy forwarded to :

- 1) The Principal Secretary to the Govt. of West Bengal, Urban Development Department.
- 2) The Director General of Police, Govt. of West Bengal, Writers' Buildings, Kolkata-700001.
- 3) The Secretary to the Govt. of West Bengal, Municipal Affairs Department.
- 4) The Commissioner of Police, Kolkata.
- 5) The Member-Secretary, West Bengal Pollution Control Board.
- 6) The District Magistrate.....District, with a request to advice his good office to circulate this direction to all SDOs., BDOs., for necessary action.
- 7) The Commissioner.....Corporation.
- 8) The Executive Officer.....Municipality.
- 9) The Secretary,Zilla Parishads, with a request for circulate this direction through his good office to the Panchayat Samity and Gram Panchayat for implementation.
- 10) The P.S. to Principal Secretary to the Govt. of West Bengal, Department of Environment.
- 11) The P.S. to MIC, Environment Department, Govt. of West Bengal.

Sd/-

Chief Law Officer,
Department of Environment.

Precautionary Measures During COVID Situation



Staff, Contractor & Subcontractor Meeting on Emergency Situation due to COVID19



Awareness Talk on COVID19 by Doctor



Awareness Talk to workmen on personal hygiene



Joyville Howrah - COVID19 Preventive Measures

19.03.2020



Screening of Govt circulated Awareness Videos



Deep cleaning maintained at camp area

Joyville Howrah - COVID19 Preventive Measures

19.03.2020



Awareness Talk & Pamphlet Distribution on DO's & DON'Ts



Provision of hand wash at site and camp entry

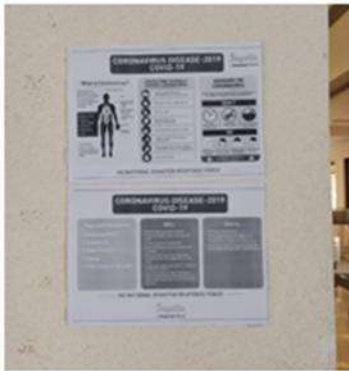

Display of DO's & DON'Ts info at offices and camps



Daily supply of food items and essentials ensured
No shortage of material still now



Washing of the food items with hot/soap water



Distribution of food and essentials maintaining social distancing

Joyville Howrah - COVID19 Preventive Measures



Daily thermalscreening of all



Daily waste disposal/
housekeeping at
living areas

Other facilities/ initiatives



Daily spraying of disinfectants/ sanitization at
office, labour accommodation, dinning hall,
vehicles, etc.

Joyville Howrah - COVID19 Preventive Measures



Daily awareness talk by Doctor & EHS team



Other facilities/ initiatives



Daily head counting



Health screening by doctor
every alternative days

Joyville Howrah - COVID19 Preventive Measures



Provision of isolation room



24X7 Security service

Other facilities/ initiatives

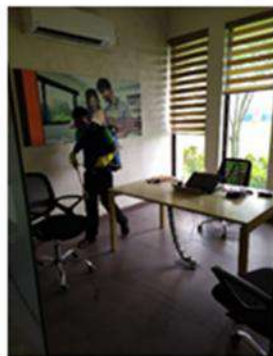

- Disinfectant spray continued at office, camp & workplaces.
- Purchased spray machine
- Disinfectant Sodium Hypochlorite purchased and maintain sufficient stock
- Dedicated people made available for carrying out disinfection, training given and provided necessary personal protective equipment.



Near project entrance
Sanitization tunnel
installed



PHOTOGRAPHS



